

# S-BOX™

POP-UP SOLUTIONS

**2-PORT POP-UP SOCKET BOX**

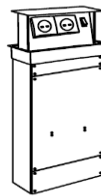

**3-PORT POP-UP SOCKET BOX**

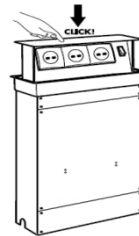

**KNIFE / SPICE / KEY / BAKERS' BOX**

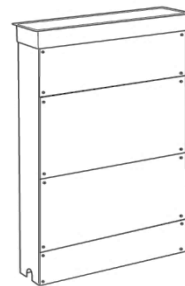

## INSTRUCTIONS AND INSTALLATION GUIDE

WE RECOMMEND THAT ALL 'CUT-OUT' PROCESSES AND/OR ANY 'CUSTOM TOP' FABRICATION SHOULD BE DONE BY YOUR SPECIALIST WORKTOP PROVIDER

There are 2 (and only 2) positions to fit an S-Box™ unit:

Either: **A - Surface-mounted**

Or: **B - 'Inset' at -20mm below surface.**

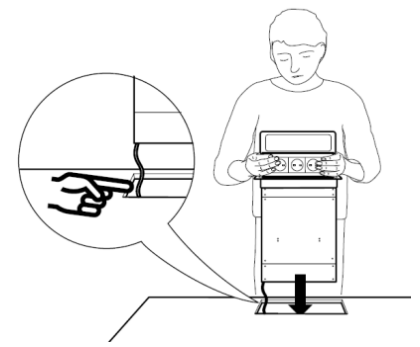

### A - SURFACE MOUNT

This simplest installation method is to insert it straight into a cut-out hole →

The fitted collar sits neatly on the worktop surface. Its own weight will keep it there. Please do not use any adhesive or sealant. (A shallow rebate can also be used if preferred to create a flush finish)

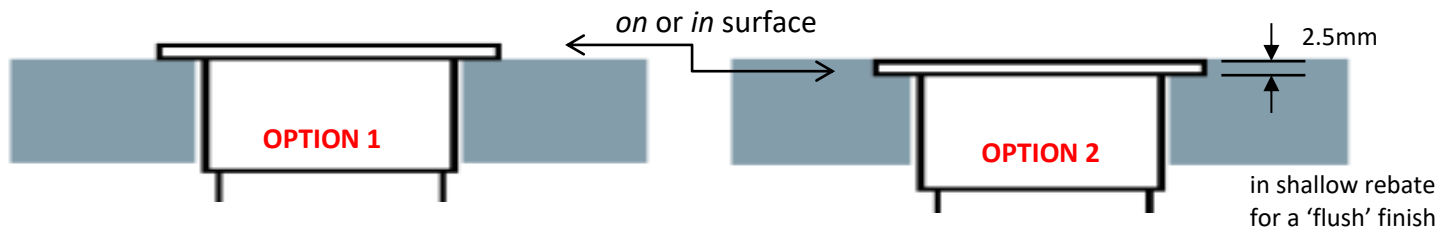

In either of these surface-mount methods, it is also possible to 'personalise' the unit, by **replacing** the steel top with a piece of matching material to the work top if required.

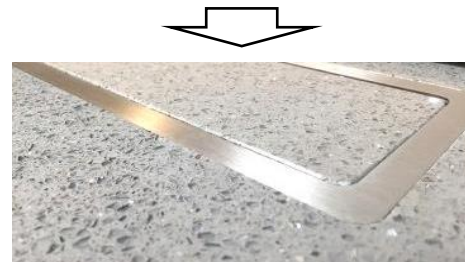

**Maximum thickness of any material is 12mm.** The Collar can be adjusted upwards to relevel it with that new material. Then please follow counterbalance "re-weight" instructions shown later in this guide.

### B - 'INSET' or REBATED – The Unique Custom ("chameleon") Installation)

This method involves the installation of the unit at exactly 20mm below the Counter-top surface so that the product can be fully disguised into its location with a custom top that matches its surroundings. This is known as an "Inset" or rebated method. **The maximum thickness of this custom top is also 12mm.**

In worktop materials of 30mm thickness and above, the installation is achieved by sitting the collar on a rebate shelf within the material.

For materials of 20mm thickness, installation is achieved by sitting the collar on a "false" rebate, created by using a second material below it.

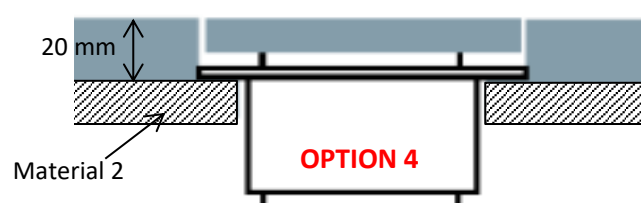
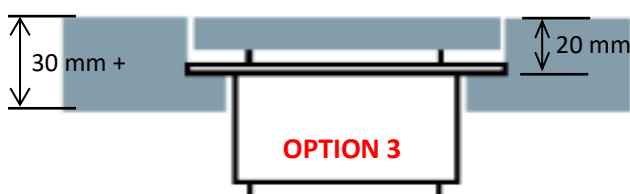

**NB. If your Worktop material is only 12mm thick (e.g. Corian or Silestone) please see thru-view Option 5**

**DIMENSIONS FOR THE PRINCIPAL 'CUT-OUT' HOLE FOR ALL INSTALLATIONS ARE:**

**2-PORT POWER BOX = 98mm x 211mm**  
**3-PORT POWER BOX = 115mm x 295mm**  
**KNIFE/SPICE/KEY/CHEF = 115mm x 425mm**

FOR A SURFACE MOUNT INSTALLATION THIS IS ALL YOU NEED. THE UNIT DROPS STRAIGHT INTO THIS HOLE AND THE COLLAR SITS NEATLY ON THE WORKSURFACE

[FOR 'FLUSH MOUNT' INSTALLATION AN ADDITIONAL 8mm WIDE SHALLOW REBATE SHOULD BE ROUTED AT 2.5mm DEPTH, WITH SUITABLE RADIUS CORNERS TO NEATLY ACCEPT THE RADIUS CORNERS OF THE COLLAR ITSELF]

PLEASE CHECK THE RADIUS OF THE COLLAR SUPPLIED BEFORE CUTTING

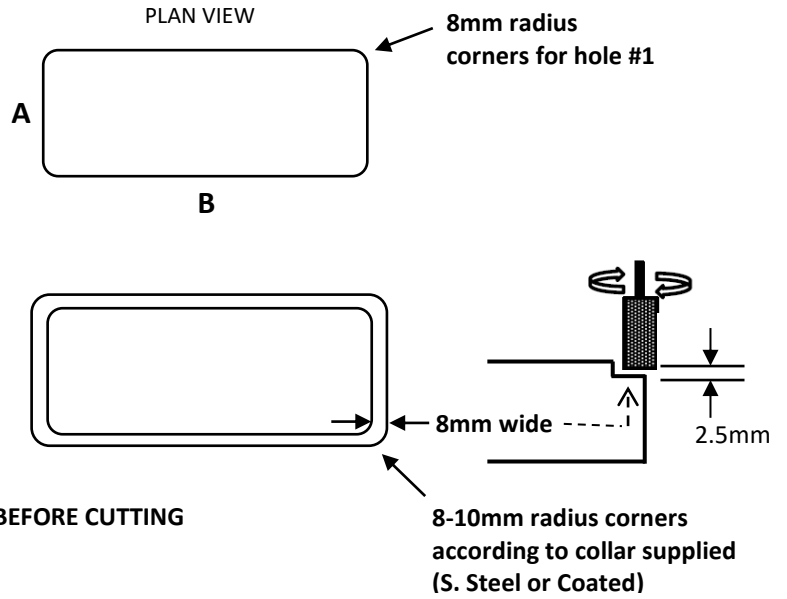

**SURFACE MOUNT THRU-VIEWS**

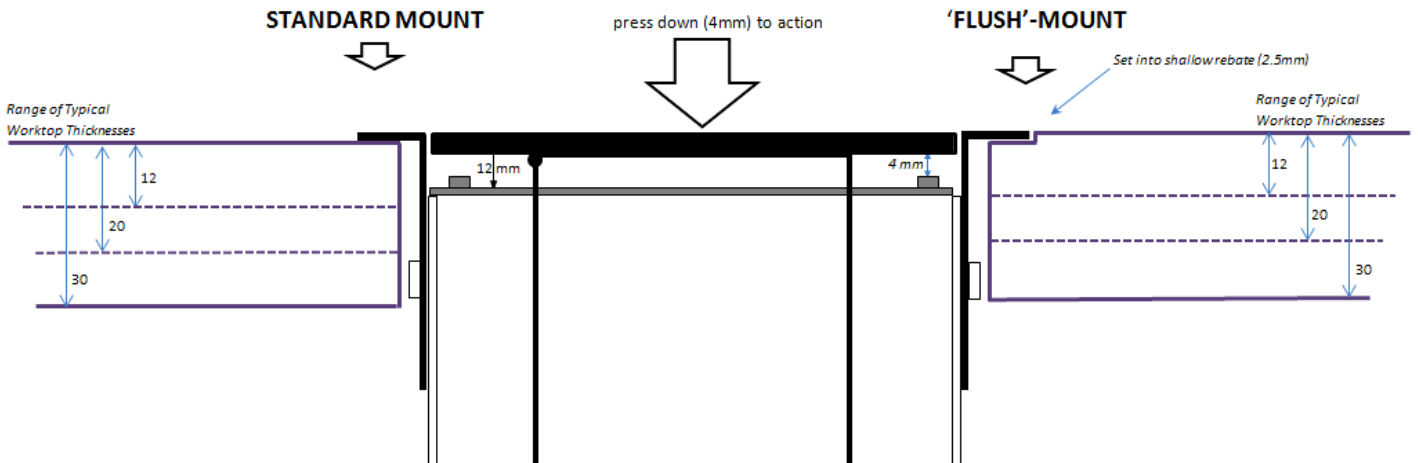

Using Top and Collar as supplied ↑

or

Custom Top option - Collar still sits on countertop but steel top has been EXCHANGED for an alternative one ↓ Please note that any custom top CANNOT be thicker than 12mm.

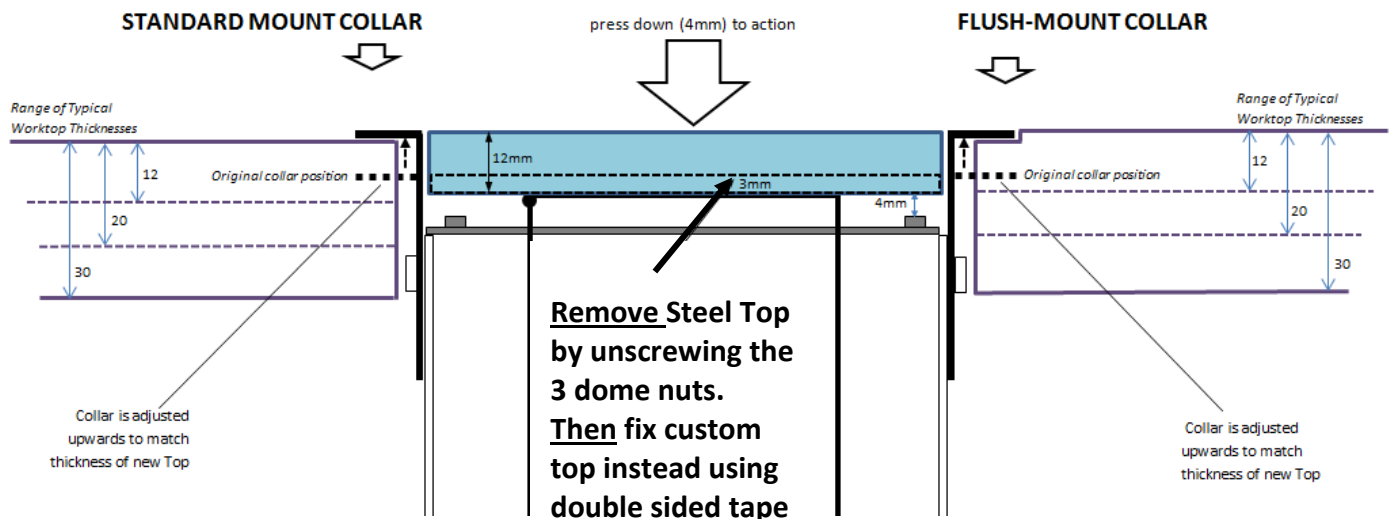

## 'INSET' (REBATED)

### - STAGE 1 (Preparing the S-Box™)

#### \*PLEASE NOTE\*

THESE STAGE 1 INSTRUCTIONS ARE TO ENABLE THE CONVERSION OF A UNIT THAT HAS A STEEL TOP AND COLLAR ALREADY FITTED WHEN IT WAS DELIVERED. IF YOU HAVE A UNIT THAT IS ALREADY PREPARED FOR A CUSTOM TOP (i.e. S-BOX CHAMELEON) YOU MAY SKIP TO STAGE 2. 😊

Remove and discard the existing Steel top - by unscrewing its 3 dome nuts.



>



Loosen the 6 Collar screws and press it down - so that it is level with the pattress metal. (See below). P.S. The pattress is the flat skirt plate shown below.



This re-creates the clearance required below the *later* new top - so that when it is pressed down it will engage and disengage the catch mechanism inside the unit. Re-tighten the collar screws (**with the new top temporarily ↓ in position**) so that the required 20mm total is achieved (**as below**)

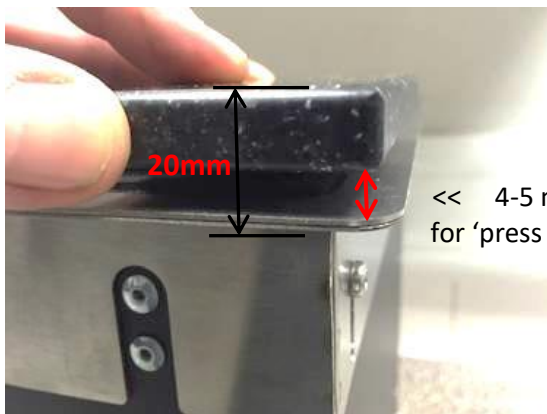

<< 4-5 mm clearance for 'press down' action

YOUR "ADAPTED" UNIT WILL LOOK LIKE THIS ↓



**Note:**  
MAX THICKNESS OF ANY  
CUSTOM TOP IS 12mm

A PRE-PREPARED "CHAMELEON"  
MODEL LOOKS LIKE THIS →



**Both can be inserted into the 20mm rebate  
and both are ready to receive the custom top**

## STAGE 2 (Preparing the rebate)

There are two ways of installing the S-Box below the work-surface. Both involve the creation of a rebate at -20mm datum. The method you chose depends entirely on the thickness of the worktop material:

>For 30mm material and above (e.g. Granite) - the rebate is made within the material itself.

>For 20mm material (e.g. Quartz) - the rebate is "created" using a second material below it (e.g. MDF)

### 'TRUE' REBATE in 30+ mm material:

Firstly cut the standard *primary* hole for insertion of the box itself (= **DIMENSIONS A x B**)

**A** 98mm x **B** 211mm (2-port)    **A**-115mm x **B**-295mm (3-port)    **A**-115mm x **B**- 425mm (storage units)

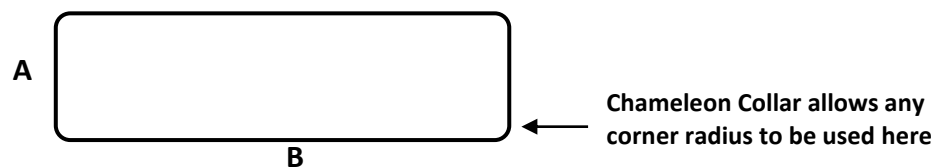

Then create a **further 8mm wide rebate at 20mm depth** from the top of the work-surface, on which to mount the S-Box, and its collar, in its new position. The radius of the collar's corners is 8mm, so we suggest that you use a maximum 10mm radius for the rebate-routing process.

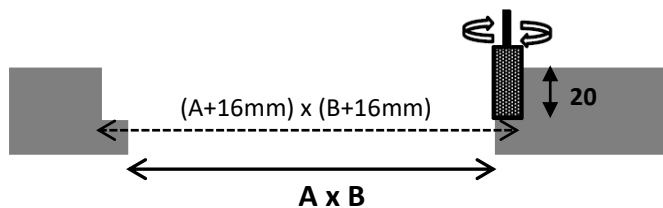

### 'FALSE' REBATE BELOW 20mm material:

This is where the rebate is being "created" using a second material below. The upper hole now becomes the Master cut in the worktop material. So 16mm needs to be **added** to both the **A** and **B** dims above to allow the collar to pass through to sit on the *second* material below.

Cut-outs for the **UPPER MATERIAL** for this method are:

**POWER BOXES** > 114mm x 227mm (2-port) or 131mm x 311mm (3-port)

**STORAGE BOXES** > 131mm x 441mm

It is the **LOWER** material that requires the Standard Dimensions **A x B** for the collar to sit on ↓

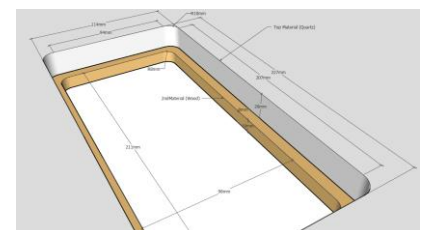
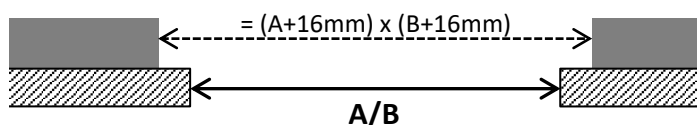

After either of the above rebate creation methods has been completed, the new top can now be created.

This should be carefully made to "marry" neatly with the larger rebated hole dimension.

Top requires correct radius (*slightly less than the hole*) and a gap of 1-1.5mm all way round to ensure clearance. As a guide: TOP DIMENSIONS = 111mm x 224mm (2-port)

= 128mm x 308mm (3-port)

= 128mm x 438mm (STORAGE BOXES)

**REMINDER! – MAX THICKNESS OF ANY CUSTOM TOP IS 12mm**

### STAGE 3 (Re-weighting the counterbalance)

The new top will be heavier than the standard stainless steel one it is replacing, so the internal counterweight box will firstly require some of the weights (*provided*) adding to it, to re-instate the correct "lift".

To do this, place the new top temporarily where the SS one used to be: ↓

Then open the front plate as shown below: ↓

*Info:*  
These fixings are  
T20 star screws >



You can now add the required amount of extra weight into the recess, until you are happy with its pace of lift (when the new top is added more permanently later)

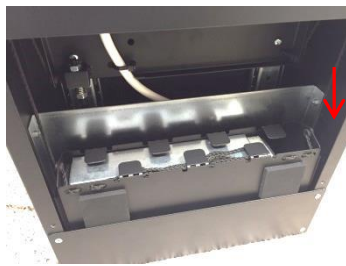

>



>



Take the New Top off and introduce the S-Box unit into its rebated hole.

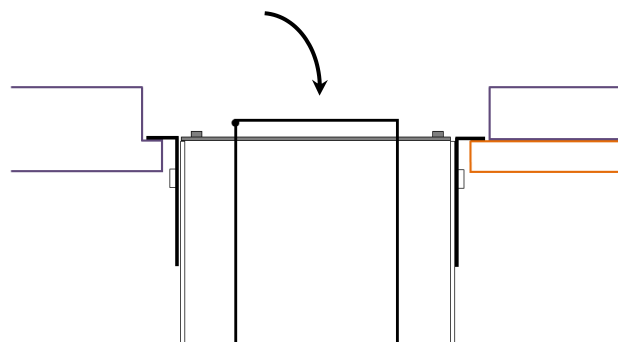
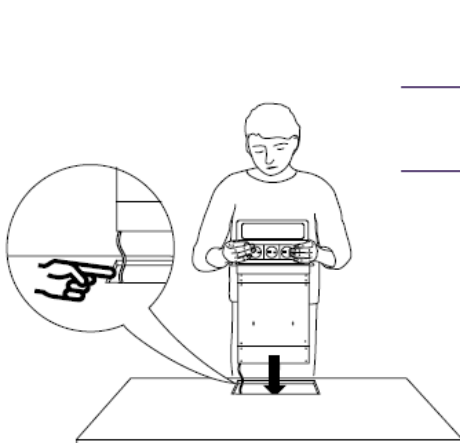

Apply good quality double-sided tape (e.g. 3M) to the plate ↗

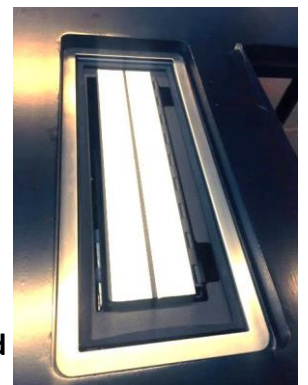

**NB.** In "CHAMELEON" Models this tape is already be fitted for you →



## STAGE 4 (Adding the new top)

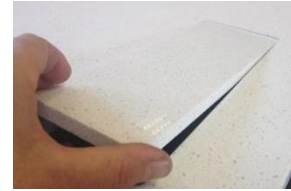

Peel back the tape and place the custom top into position.

Using Tape allows you to have a few goes at getting the perfect position for the top before pressing it firmly home and letting the tape adhesive to bond and cure.

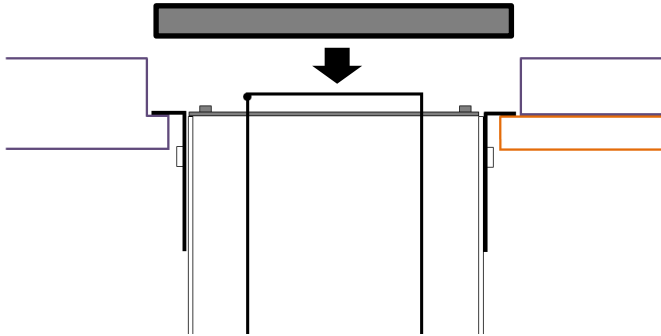

Any final “fine-tuning” of levels, if still required, can be achieved by adjusting the male ball’s position so that in the closed (*catch-engaged*) position, your new top and adjacent surface are perfect. By twisting the threaded ball part, and holding the top nut, the position of the ball can be raised or lowered by the tiniest of amounts.

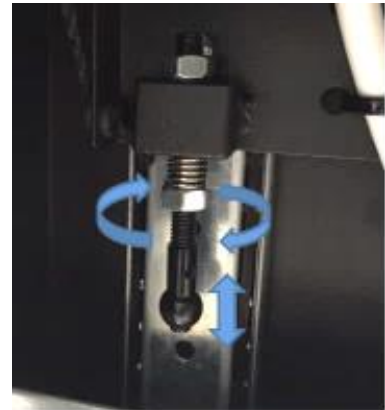
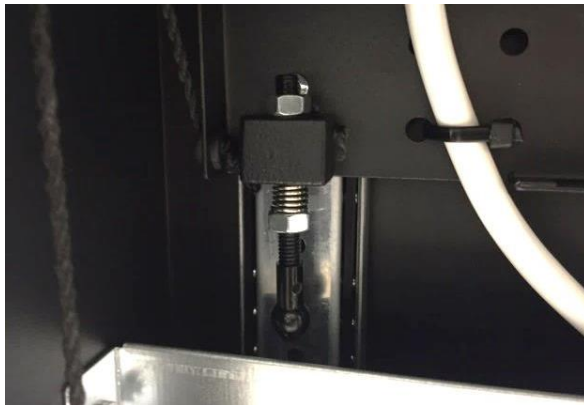

You can now fix the front back on - and ENJOY YOUR CUSTOMISED POP-UP SOLUTION! 😊

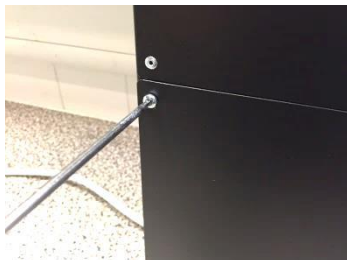

**Please Note:**

**All electrical connections for the Power Box unit must be carried out by a fully Qualified Electrician.**

# COMPARISON THRU-VIEW

(True rebate in solid material or "false rebate" below 20mm material)

## OPTION 3

(30mm or greater material)

### TRUE REBATE METHOD

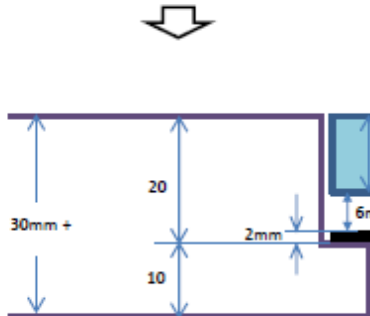

Uses existing collar  
(Re-positioned lower as shown)

press down (4mm) to action

CUSTOM TOP

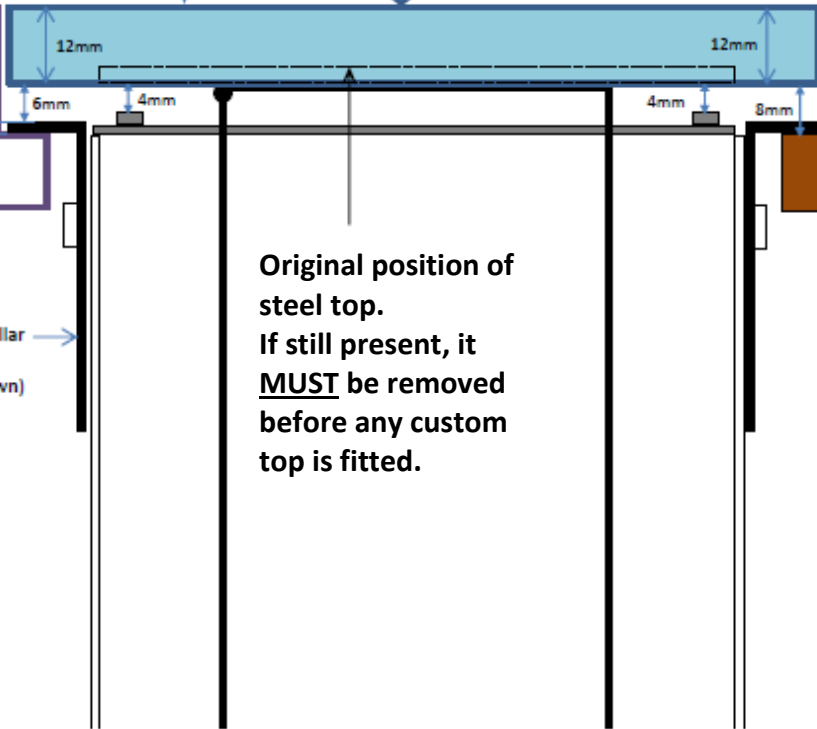

Original position of steel top.  
If still present, it **MUST** be removed before any custom top is fitted.

## OPTION 4

(20mm material)

### FALSE REBATE METHOD

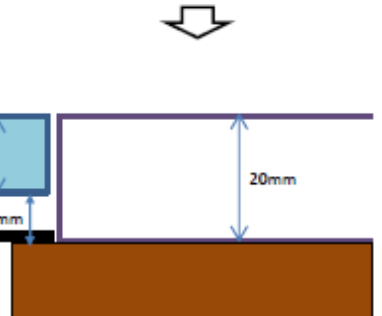

Second material creates rebate for collar to sit on.  
(Suggested thickness 10mm minimum)

## OPTION 5

INSTALLATION BELOW 12mm MATERIAL – using a 12mm top also.

(by use of an additional 18mm layer, to create the rebate at -20mm depth for Collar to sit on)

press down (4mm) to action

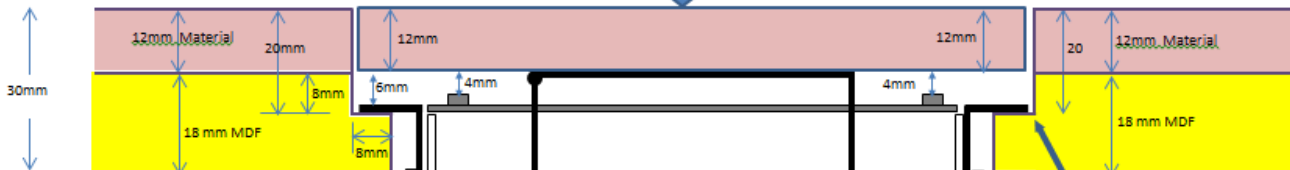

Uses existing collar  
(Re-positioned as above)

8mm x 8mm rebate



## 2-PORT DIMENSIONS

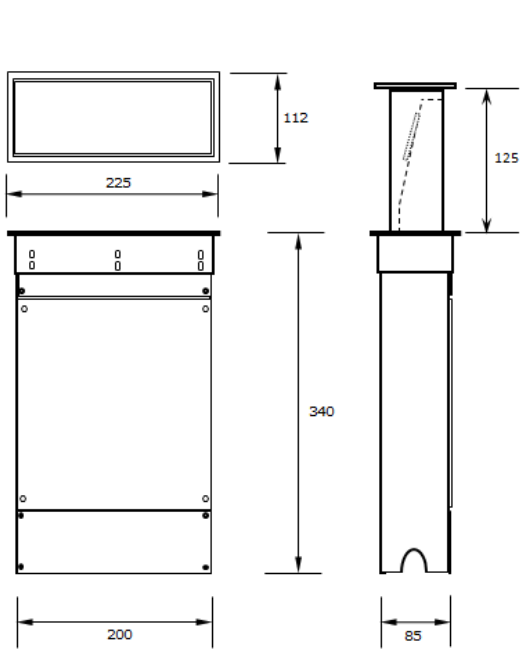

## 3-PORT DIMENSIONS

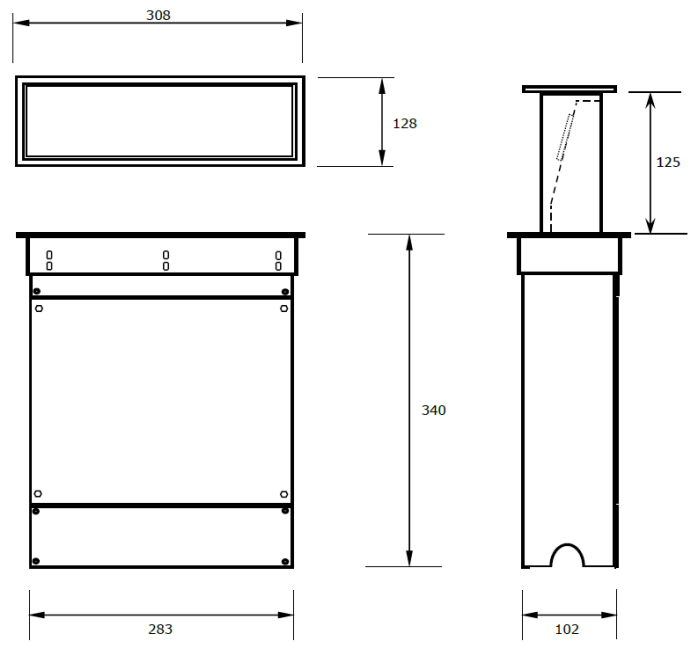

## STORAGE BOX DIMENSIONS (Knife, Spice etc)

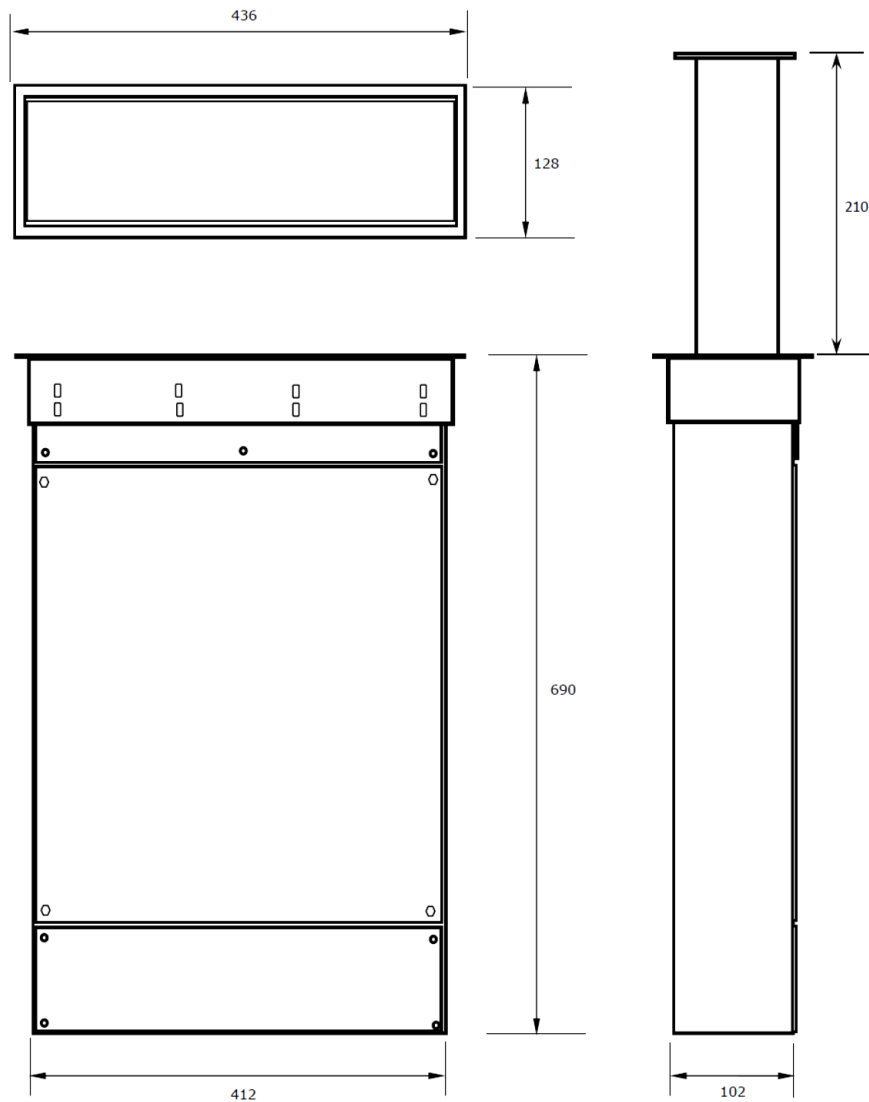

## **WARRANTY AND OTHER INFORMATION**

### **Important Safety Information. Please read carefully before installation.**

1. Unit must be installed by qualified personnel, according to manufacturer's instructions and relevant local standards.
2. Ensure electrical supply complies with current regulations and has suitable electrical protection device fitted.
3. Do not attempt to modify unit in any way.

### **Child Safety**

This unit is designed to be operated by adults only. Do not allow children to operate. Some components could be hazardous to children.

Keep all items out of reach and do not leave children unattended near unit.

### **During Use**

This unit is for domestic use only and not for commercial purposes. Do not use unit if subjected to water penetration.

Do not use any of the electrical components or appliances contained within the unit with wet hands.

### **Electrical Connections**

Any electrical work required to install this unit must be carried out by a qualified electrician or competent person, in accordance with current IEEE regulations.

### **THE UNIT MUST BE EARTHED (Where Appropriate)**

The manufacturer declines any liability if safety measures are not observed. Before switching on ensure electrical supply

voltage matches indicated voltage on base of unit or documentation supplied.

### **Cleaning Instructions**

**Top Surface** A damp cloth or sponge with a solution of washing liquid will remove everyday stains.

**Raising Unit** Dry cloth and anti static spray should clean unit and stop dust gathering on surfaces.

**AFTER 6 -12 MONTHS USE (PARTICULARLY IN VERY WARM or CENTRALLY HEATED ENVIRONMENT) THE INTERNAL RUNNERS MAY REQUIRE A TINY AMOUNT OF RE-LUBRICATION TO MAINTAIN THE UNIT'S SMOOTH OPERATION.**

## Unit Operation

The unit works on a counterbalance system, during the design process and manufacture we have calculated and installed the correct counterbalance weight to allow the unit to operate smoothly and efficiently.

By applying a small amount of pressure to the top of the unit you will hear a click which is the hold catch releasing. The unit will now raise. You can now use the contents for its designed purpose.

When you have finished, simply apply a small amount of pressure to the top and push the unit back down, you will hear a click which is the hold catch activating and holding the unit closed.

## Compliance



Not all S-Box products require CE/UL Approval but those that do have gained it.

The S-Box has undergone extensive testing by FIRA (Furniture Industry Research Association) and has passed the testing Criteria.



Expertise • Independence • Integrity

## Guarantee Conditions (UK)

1. S-Box offers the following guarantee to the first purchaser of the unit.
2. The guarantee is valid for 24 months once handed to first retail purchaser. This is verified by purchase invoice or similar document.
3. This guarantee does not cover commercial use.
4. Guarantee covers all parts/components which fail due to faulty workmanship or materials. It does not cover defects or poor performance due to misuse, accidental damage, neglect, faulty installation, unauthorised modification or attempted repair, commercial use or failure to observe requirements/recommendations set out in this manual.
5. Guarantee does not cover light bulbs, removable glassware or plastics.
6. Should guarantee repairs be necessary the purchaser must inform the nearest S-Box service centre (manufacturer's service or authorised agent workshop). S-Box reserves the right to stipulate place of repair i.e . customer's home, place of installation or S-Box Workshop
7. Repairs carried out under guarantee do not extend guarantee period. The guarantee or free replacement does not include installation. Parts removed during guarantee repairs become S-Box property.
8. The purchaser's statutory rights are not affected by this guarantee.

## Customer Record

The model and serial numbers of the unit can be found on the bottom of the unit. Please record this information below and keep this manual for future reference.

Model \_\_\_\_\_ Serial Number \_\_\_\_\_

# S-BOX™

POP-UP SOLUTIONS

WE RECOMMEND THAT ALL 'CUT-OUT' PROCESSES  
AND/OR ANY 'CUSTOM TOP' FABRICATION SHOULD  
BE DONE BY YOUR SPECIALIST WORKTOP PROVIDER

S-Box™ is a registered trademark of Cardinal IP Limited  
The S-Box™ product innovation is protected by Patents - registered to Cardinal IP Limited

**Cardinal Innovations Limited**  
Battye Street, Bradford  
West Yorkshire, ENGLAND BD4 8AG  
**Tel:** +44 (0)1274 386820 **Email:** sales@the-sbox.com  
**Web:** www.the-sbox.com