



Norcool – Cave 40

The Cave 40 offers perfect wine storage for connoisseurs who love to savor their wine with friends. It's ideal for everyday use but offers a large storage capacity for approximately 40 standard 75 cl bottles of wine, meaning there's room for wine to suit everyone's taste.

Product benefits:

- Capacity for approx. 40 standard 75 cl bottles of wine
- High quality oak shelves
- Interior LED lighting with door sensor
- Ultra Violet resistant door glass to provide protection against the harmful effects of the sun on the wine
- Adjustable electronic thermostat
- Low noise level
- Supplied as an integrated model
- Must stand on its own between two modules



Technical Information on Norcool - Cave 40



Energy consumption: 128,8 kWh/year (A)



Capacity: Approx. 40 standard 75 cl wine bottles



Lighting: Light emitting diodes (LED)



Thermostat setting: 8-15 °C



For Integration: Yes, but must stand on its own feet



Weight: 43 kg net

| | |
|---------------------------------|---|
| Exterior dimensions: | W595 x H820-895 x D546 mm |
| Niche dimensions: | W600 x H820 (min) x D546 mm |
| Capacity: | Approx. 40 standard 75 cl. wine bottles |
| Thermostat setting: | 8-15 °C |
| Ambient temperature: | 10- 27 °C |
| Weight: | Net 43 kg |
| Defrosting: | Automatic |
| Insulation: | CFC- free polyuretan foam |
| Door glass: | Tinted safety glass with UV protection |
| Lighting: | Light emittion diodes (LED) |
| LED color: | White |
| Door hanging: | Order left or right hinged |
| Handle: | Stainless steel |
| Cold production: | Compressor |
| Coolant: | R134A |
| Volt/ hz: | 220-240V AC 50 Hz |
| Energy consumption: | 128,8 kWh/year (Energy class A) |
| Power extension cord: | 2,6 m |
| Ventilation requirement: | 130cm ² (given with the product) |

Technical drawing of Norcool – Cave 40

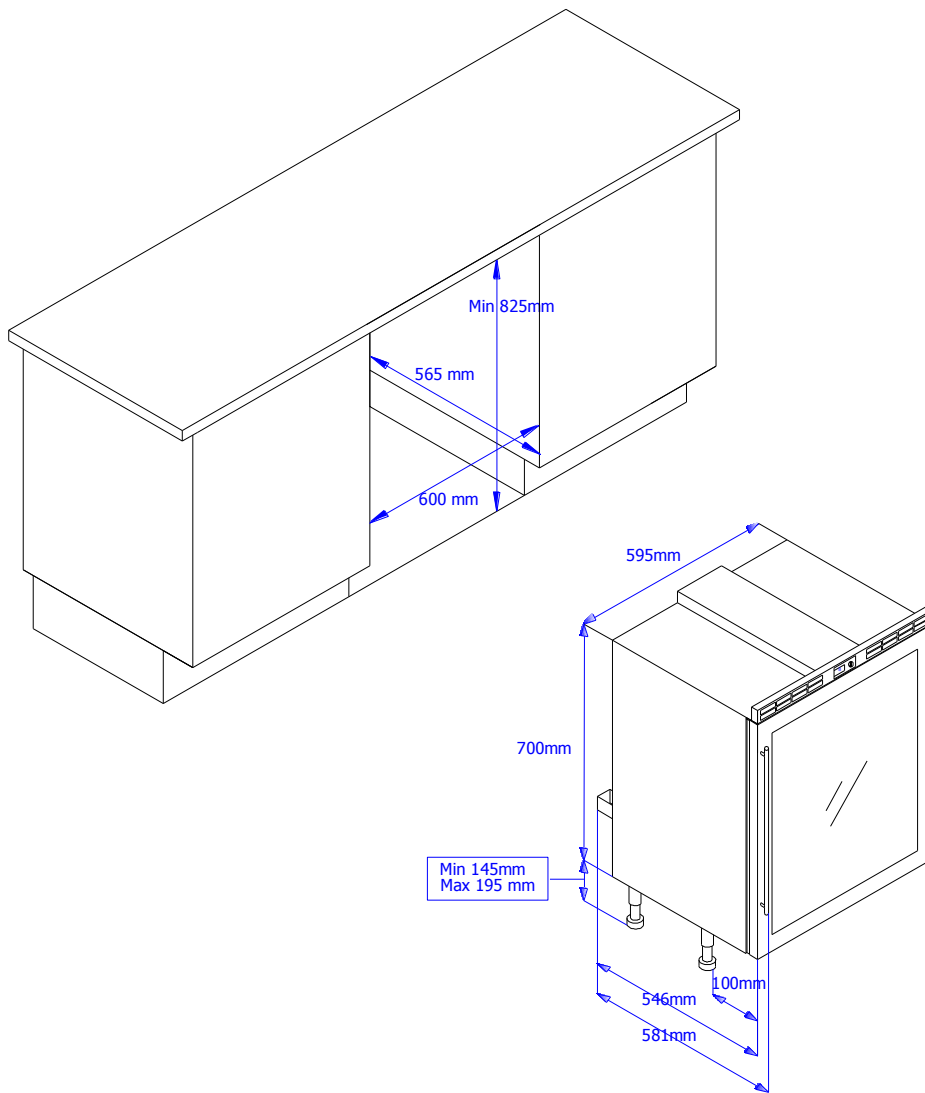
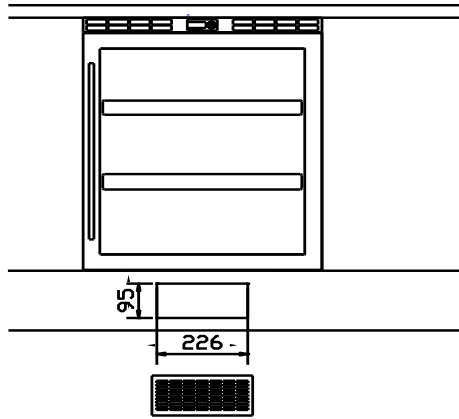

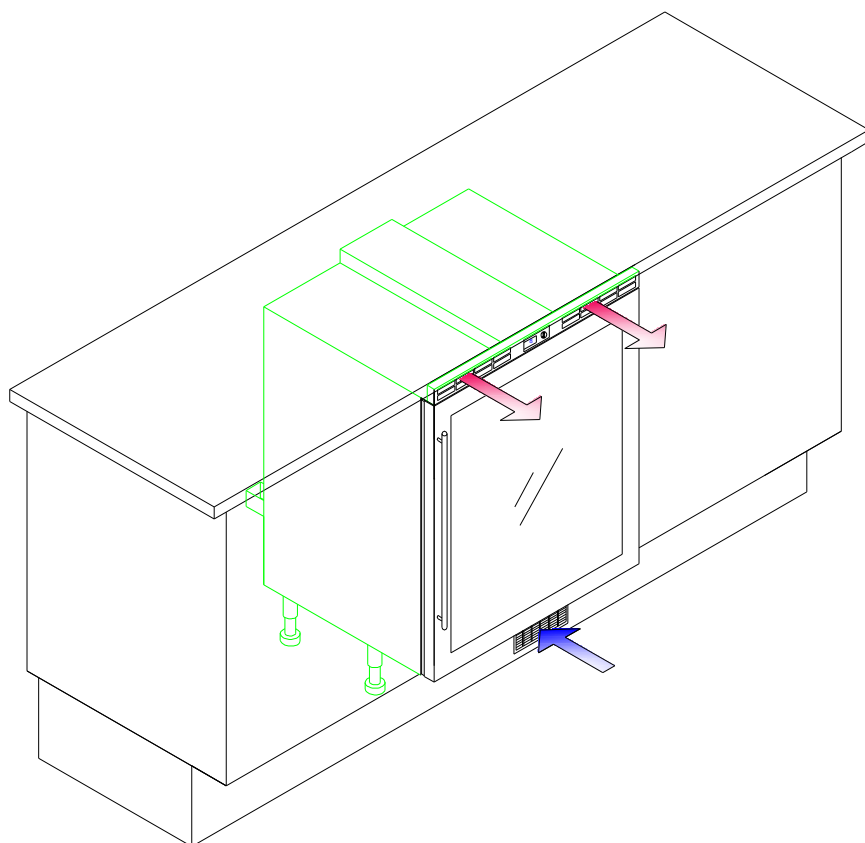

Cave 40 Right hinged
Cave 40 Left hinged

Product number: 12400008
Product number: 12400118