



Mixer Tap Gamma 3 vie - satin

Mixer Taps

Code: 8496 100



DETAILS

Mixer type	Three-way mixer tap with dual control and rotating barrel. Made in AISI 316 stainless steel.
------------	--

Material	Stainless steel AISI 316
----------	--------------------------

Texture	Satin
---------	-------

Rotating angle	360°
----------------	------

Strengthening plate	ø50mm
---------------------	-------

Cartridge	With ceramic discs
-----------	--------------------

Mixer hole	ø35mm
------------	-------

Max worktop thickness	50mm
-----------------------	------

FEATURES

Aisi 316 stainless steel

Made in AISI 316 stainless steel, which guarantee a perfect resistance to corrosion and maximum hygiene and safety, even for food use water.

Rotating angle

All the taps have a wide angle of rotation. Some models even permit a full 360° rotation.

Strenghtening plate

Foster's mixer taps are equipped with the strenghtening plate that offers perfect stability on any sink.

TECHNICAL DATA

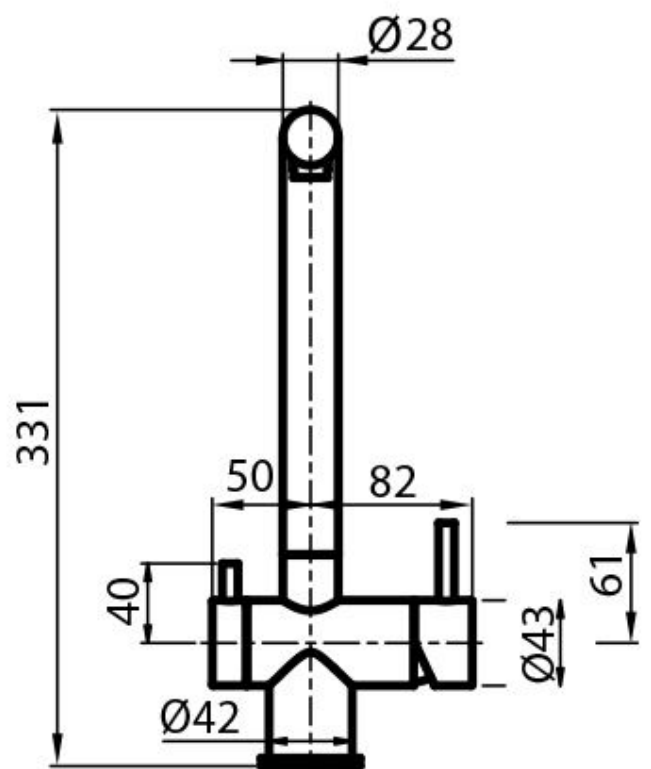
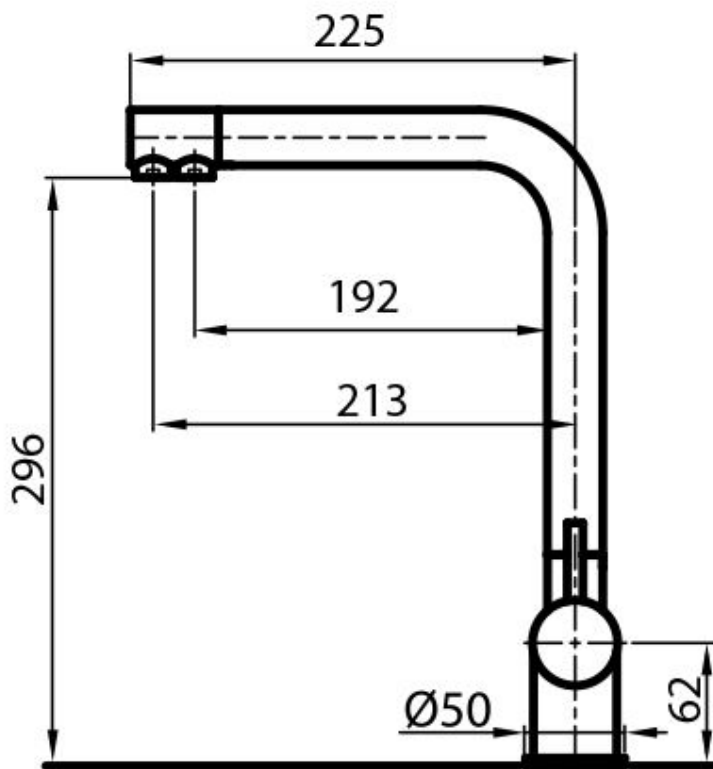

GALLERY

