

TEMPTECH



PRODUCT CATALOG 2019

Wine cabinet | Fridge | Retro fridge | Backbar and display fridge | Icemaker

TEMPTECH

Discover the best of your wine.



TEMPTECH

Contents

Inspiration & tips

- 4** Tips when buying a wine cabinet
- 6** How to store wine correctly
- 8** Ideal serving temperature
- 10** Wine cabinet technology

Wine cabinets

- 12** TREND wine cabinets
- 16** PERFORMANCE wine cabinets
- 18** PREMIUM wine cabinets
- 26** OSLO wine cabinets
- 36** ELEGANCE wine cabinets
- 40** COPENHAGEN wine cabinets

Fridges and minibars

- 42** Retro fridge
- 46** Partycooler
- 47** Fridge
- 48** Minibar and minifridge

Professional fridges and icemakers

- 50** Backbar
- 52** Display fridge
- 56** Ice maker

Installation drawings

- 58** Installation drawings for wine cabinets

TEMPTECH

Borgeskogen 30
3160 Stokke
Norway

Tel. +47 333 67 000
post@temptech.no

🖱 www.temptech.no
📘 [Facebook.com/temptechproducts](https://facebook.com/temptechproducts)
📷 [Instagram.com/temptechproducts](https://instagram.com/temptechproducts)

Design: Temptech AS
Print: BK Grafisk AS
Photos: Epoq, Istockphoto, Temptech AS
Subject to errors and product changes.



Ideal conditions

With a Temptech wine cabinet you always have correct tempered and ready-to-serve wine!

Tips when buying a wine cabinet

With a wine cabinet you can store your wine collection in the correct way and you will always have the right tempered wine to serve! Here you will find some tips and advice on what to think about when buying a wine cabinet.

Temptech is the Nordic region's largest producer and supplier of wine cabinets. Our wine cabinets meet the highest demands on design and technology and ensures an optimal environment for wine storage. It is not without reason that well-known restaurants, wine bars, wine importers and wine connoisseurs choose our wine cabinets. In our wine cabinets the wine bottles is properly stored in correct and stable temperature and correct humidity. The wine cabinets have low noise and low vibration that does not impair the quality of the wine.

Temptech has a wide range of wine cabinets with over 50 different models of various dimensions, capacities and price rangers, for private or professional use. We have the wine cabinets to be built in kitchen, for full integration, large wine cabinets and small, freestanding models. We have wine cabinets that meets all needs and wishes!

For the love of wine!

A properly tempered and preserved wine will give the wine

a better taste and can even bring a better wine experience. At the same time, proper storage will provide better durability for the wine. The correct serving temperature relative to the wine type, grape and maturity of the wine is important. Store your wine bottles in a wine cabinet, and you ensure that you have the optimal environment for your wine collection.

Cooling technology

Our wine cabinets use compressor or thermoelectric cooling technology. With a compressor, the wine cabinet is cooled in the same way as a regular refrigerator. A compressor will produce some noise and vibration. To protect the wine against vibration we have developed special bumpers that absorb nearly all vibration made by the compressor. Normal sound level from our wine cabinets is 38-40 dBA. The sound level for each specific model is specified in the specifications.

Our smaller, stand-alone wine cabinet uses thermoelectric cooling where the temperature in the wine cabinet is electronically adjusted. A fan inside the wine will circulate

the cool air. To achieve the desired temperature in the thermoelectric wine cabinets it is important that the wine cabinet is placed free-standing with good ventilation and placed in a room with normal room temperature between 20 and 25°C. Since the thermoelectric wine cabinets do not have any compressors, they are low on sound and vibration.

Temperature zones and settings

Wine cabinets come with a single, dual or triple temperature zones. The temperature zones can be regulated individually. A dual temperature zone wine cabinet have a temperature range between 5 to 22°C, where the coldest temperature zone can be set between 5 and 12°C and the second zone between 12 and 22°C. However, it is not possible to set both zones at 12°C. There must be 1°C difference between the two zones (one zone may be 12°C, while the other one must be 13°C).

For storage of ready-to-serve white wine, it is recommended to set the temperature at 6°C, for red wine 14°C. For long-term storage of wine, the recommended temperature is 12°C, which will be optimal for all types of wine.

How large wine cabinet is needed?

Wine collections tends to have an amazing way of growing, and fast! When buying a wine cabinet, if space and budget allows, its recommended to get one that has 25-50% more capacity than the size of your current wine collection.



Made for kitchen

Our Premium and Oslo wine cabinets have standard dimensions and are made to be built in or be integrated in the kitchen.

Models for built-under, built-in, integrated, freestanding

Temptech has wine cabinets to be built under the kitchen worktop, for full integration in the kitchen and freestanding models. The built-under models, Premium and Elegance, can easily be placed in a niche under the worktop with no plinth in front. Our built-in Oslo wine cabinets are designed for full integration in the kitchen, under the worktop with plinth in front, or in high cabinets. Our freestanding models, Trend and Performance, needs to have extra space and good ventilation.

Bottle capacity - how many bottles will fit?

Wine bottles come in many different sizes and shapes. Therefore, there is used a standard bottle dimension (75CL Bordeaux bottle) to indicate the bottle capacity of the wine cabinet. Normally, a wine collection contains bottles of various sizes and shapes. A simple rule is that the wine cabinet can store around 70-80 % of the indicated bottle capacity.

Correct humidity

Proper humidity is as important as the correct temperature when storing wine. Too dry air will make the cork dry out and too moisture air will damage the labels and can cause the cork to rot. Proper humidity should be at 50-70 %, which all Temptech wine cabinets handles.

What about the sound level?

The wine cabinet will make some sound from the compressor and the fan inside. Our wine cabinets has a sound level from 38-40 dBA.

Not only wine bottles!

A wine cabinet is also the perfect place to store wine on bag-in-box, just take out the plastic bag from the box and place it in the wine cabinet. Wine cabinets are also perfect for storing cigars, chocolate, gin and other spirits.



The 5 golden rules
Follow these rules to ensure that
you store your wine collection at
the best possible conditions!

The 5 golden rules **How to store wine correctly**

A properly tempered and preserved wine will give the wine a better taste and can even bring a better wine experience. At the same time, proper storage will provide better durability for the wine.

Wine is a living product, evolving over time. For optimal and accurate storage, there are five golden rules that are important to follow. If you choose a wine cabinet from Temptech, you can ensure that you store your wine bottles at the best possible conditions.

1. Correct and constant temperature

It is important not to store the wine too warm or too cold. In general, all wines can be stored at around 10-12°C. To separate between white and red wine, white wine should be stored around 6-10°C while red wine is being best stored at around 14-18°C.

2. Humidity

In order for the wine cork not to dry in and to begin to leak in air (which can ruin the wine) it is important with a proper humidity. Proper humidity should be at 50-70 %, which all Temptech wine cabinets has.

3. Protection against light and UV-rays

Wine is sensitive to light which can make the ripening process of the wine accelerate. Sunlight also

contains UV-rays that may be harmful to the wine. Most of our wine cabinets are equipped with protective, UV filter on the glass door. The interior LED lighting does not emit any heat either.

4. Protection against odor

Odor may penetrate the cork and deteriorate the quality of the wine. Odor can come from wooden shelves used in the wine cabinet. We only use untreated, wooden shelves that do not give off any odor. In addition, our wine cabinets are equipped with an active coal filter that cleanses the smell of the air in the wine cabinet.

5. Low vibration

Vibration over time will be harmful and affect the development of the wine. Vibration can occur from the compressor and spread out to the bottles via the shelves in the wine cabinet. Our specially designed vibration bumpers significantly reduces the vibration from the compressor.



Ideal serving temperature

The correct temperature of the wine you serve is essential for an optimal taste experience. Very often red wines are served a few degrees too warm and white wines too cold. A too warm or too cold wine will lose its flavours and palette.

Storing wine in a wine cabinet brings the wines to an ideal serving temperature. Using a wine cabinet with several temperature zones allows you to always have ready-to-serve white and red wine. In general, a wine is better served a few degrees too cold, than too warm. The temperature will always increase slightly when the bottle is placed on the table and served in the glasses. Therefore, a good tip is to set the temperature zone 1-2°C lower than the intended serving temperature. A simple rule for serving temperature is to serve young and light wines some chilled and older and more complex wines at a higher temperature. This applies to both white and red wines.

White wines are served best at temperatures around 7-10°C depending on the type of white wine. For example, a crisp and dry riesling is served a bit cooler than a full-bodied chardonnay.

Red wines are served best between 12°C to 18°C. Also here depending on the type of red wine. For example, a light and fruity valpolicella is served a little cooler than a rich, full-bodied and complex bordeaux. If you keep your wine for a long-term storage in the wine cabinet, the serving temperature is not that important. Red wine, white wine, sparkling and fortified wine can all be stored at the same temperature around 10-12°C.

With a dual temperature zone wine cabinet, you can for example set one zone for ready-to-serve white wine and the other zone for red wine. You can also divide the zones with one zone for serving-ready wine, and the second zone for long-term storage - there are many opportunities!

Below you find an overview of the ideal serving temperatures recommended for different types of wines. Remember, it's advisable to set the temperature of the wine cabinet 1-2°C below this, as the wines will increase slightly in temperature after serving. Cheers!

Ideal serving temperature

Sparkling wine	6 - 8°C
Champagne	8 - 11°C
Light, dry white wine	7 - 9°C
Full-bodied white wine	9 - 12°C
Light red wine	12 - 14°C
Medium-bodied red wine	14 - 16°C
Full-bodied red wine	16 - 18°C
Fortified wine	16 - 18°C





Optimal storing conditions

Our wine cabinets meets the strictest requirements for design and technology and ensures optimal storage conditions for your wine collection.

Wine cabinet technology

A wine cabinet is not just a refrigerator with a glass door. Here is an overview of the components that makes a wine cabinet.

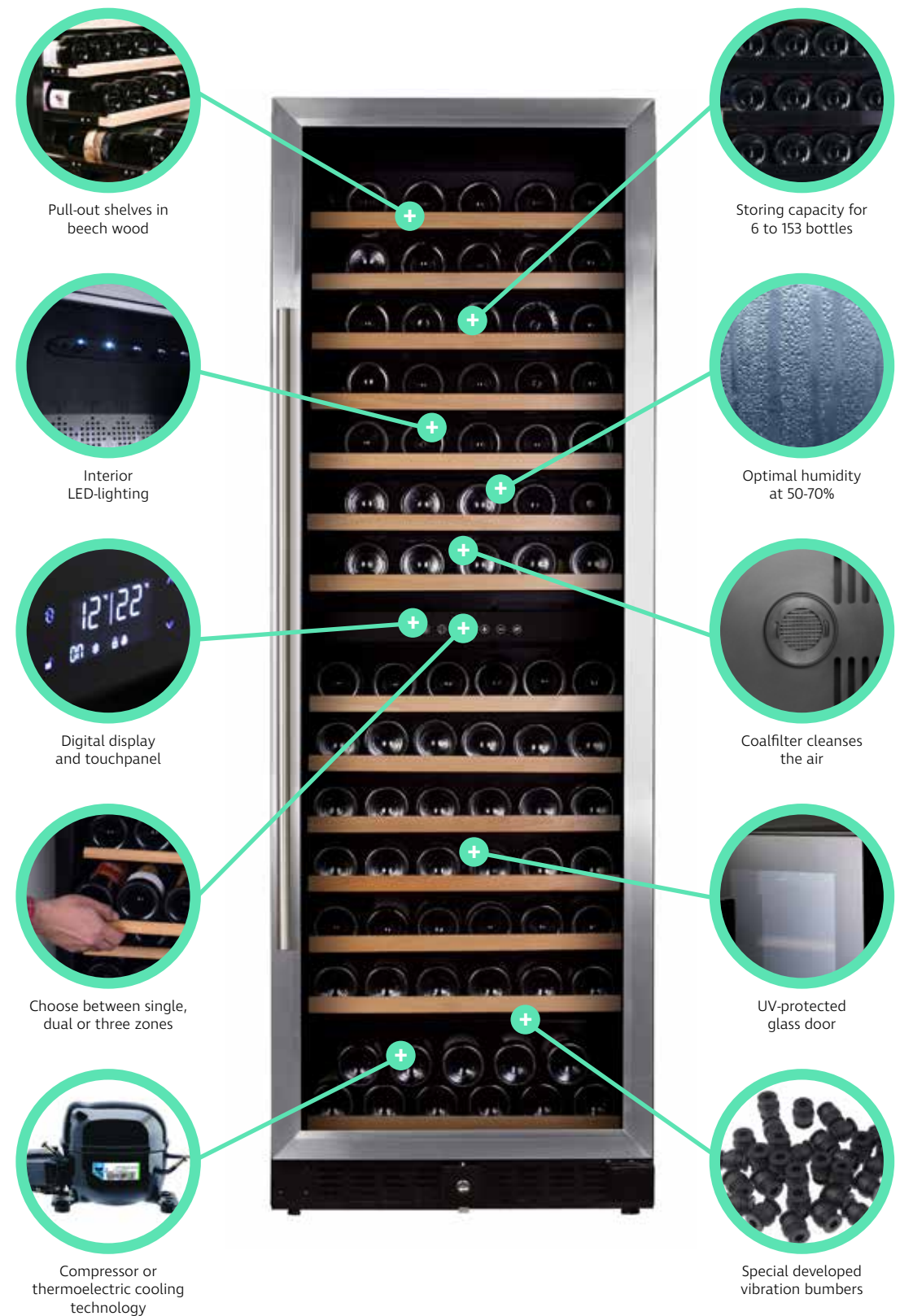

FW78DB

Serve your wine at the perfect drinking temperature! Dual temperature zone and capacity for 32 bottles.

FW16SB

Perfect wine cabinet for smaller places. Single temperature zone (12-18°C) and capacity for 6 bottles.

Trend Ideal storing for the wine lover or the connoisseur

Our TREND wine cabinets meets the highest demands on design and technology and ensures an optimal environment for wine storage.

These freestanding wine cabinets is the ideal solution for any wine lover, wine connoisseur or for professional use.

With thermoelectric cooling the wine cabinets will not produce any noise or vibration - convenient for both you and your wine!

Choose between a single (adjustable between 12 to 18°C) or dual temperature zone (adjustable from 8-12°C and 12-18°C). Since the wine cabinets uses thermoelectric cooling it is important to place the wine cabinet in a normal room temperature at 20-25°C so the wished temperature can be reached.

These quality wine cabinets have an exclusive look with a tinted glass front with integrated handle. The digital display and touchpad on the front of the door gives an easy monitoring and adjusting temperature and light. Internal LED lighting and metal pull-out shelves gives a good over-view of your wine bottles.



TREND wine cabinets



TREND FW23SB

- Tinted glass door
- Integrated handle
- Single zone (12-18°C)
- 8 bottles
- Pull-out metal shelves
- Interior LED lighting
- Digital touchpanel on door
- Low noise
- Vibration-free
- Thermoelectric cooling

Specifications
Bottle capacity: 8
Temperature zones: 1
Temperature: 12-18°C at 20-25°C room temperature
Shelves: 2
Capacity: 23L
Soundlevel: 38 dBa
Reversible door: No
Built in: No
Freestanding: Yes
Lock: No
UV glass: Yes
Coal filter: No
Interior lighting: LED (white)
Voltage: 220-240V
Power consumption: 50W
Product weight: 8,7 kg
Package weight: 10 kg
Product dimensions (WxHxD): 410x273x502
Package dimensions (WxHxD): 460x365x567
Cooling: Thermoelectric
Certification: CE, GS, RoHs
Energy efficiency class: A+
Climate class: N
Annual power usage: 95 kwh
Production country: China
EAN: 7090013676128



TREND FW16SB

- Tinted glass door
- Integrated handle
- Single zone (12-18°C)
- 6 bottles
- Pull-out metal shelves
- Interior LED lighting
- Digital touchpanel on door
- Low noise
- Vibration-free
- Thermoelectric cooling

Specifications
Bottle capacity: 6
Temperature zones: 1
Temperature: 12-18°C at 20-25°C room temperature
Shelves: 2
Capacity: 16L
Soundlevel: 38 dBa
Reversible door: No
Built in: No
Freestanding: Yes
Lock: No
UV glass: Yes
Coal filter: No
Interior lighting: LED (white)
Voltage: 220-240V
Power consumption: 50W
Product weight: 8 kg
Package weight: 9,5 kg
Product dimensions (WxHxD): 252x378x515
Package dimensions (WxHxD): 302x460x562
Cooling: Thermoelectric
Certification: CE, GS, RoHs
Energy efficiency class: A
Climate class: N
Annual power usage: 114 kwh
Production country: China
EAN: 7090013676111



TREND FW33SB

- Tinted glass door
- Integrated handle
- Single zone (12-18°C)
- 12 bottles
- Pull-out metal shelves
- Interior LED lighting
- Digital touchpanel on door
- Low noise
- Vibration-free
- Thermoelectric cooling

Specifications
Bottle capacity: 12
Temperature zones: 1
Temperature: 12-18°C at 20-25°C room temperature
Shelves: 5
Capacity: 33L
Soundlevel: 38 dBa
Reversible door: No
Built in: No
Freestanding: Yes
Lock: No
UV glass: Yes
Coal filter: No
Interior lighting: LED (white)
Voltage: 220-240V
Power consumption: 50W
Product weight: 11,3 kg
Package weight: 13,4 kg
Product dimensions (WxHxD): 252x616x515
Package dimensions (WxHxD): 300x700x555
Cooling: Thermoelectric
Certification: CE, GS, RoHs
Energy efficiency class: A
Climate class: N
Annual power usage: 130 kwh
Production country: China
EAN: 7090013676135



TREND FW48SB

- Tinted glass door
- Integrated handle
- Single zone (12-18°C)
- 18 bottles
- Pull-out metal shelves
- Interior LED lighting
- Digital touchpanel on door
- Low noise
- Vibration-free
- Thermoelectric cooling

Specifications
Bottle capacity: 18
Temperature zones: 1
Temperature: 12-18°C at 20-25°C room temperature
Shelves: 5
Capacity: 48L
Soundlevel: 38 dBa
Reversible door: No
Built in: No
Freestanding: Yes
Lock: No
UV glass: Yes
Coal filter: No
Interior lighting: LED (white)
Voltage: 220-240V
Power consumption: 50W
Product weight: 14 kg
Package weight: 16 kg
Product dimensions (WxHxD): 355x648x510
Package dimensions (WxHxD): 411x733x560
Cooling: Thermoelectric
Certification: CE, GS, RoHs
Energy efficiency class: B
Climate class: N
Annual power usage: 171 kwh
Production country: China
EAN: 7090013676142

TREND wine cabinets



TREND FW65SB

- Tinted glass door
- Integrated handle
- Single zone (12-18°C)
- 28 bottles
- Pull-out metal shelves
- Interior LED lighting
- Digital touchpanel on door
- Low noise
- Vibration-free
- Thermoelectric cooling

Specifications
Bottle capacity: 28
Temperature zones: 1
Temperature: 12-18°C at 20-25°C room temperature
Shelves: 6
Capacity: 65L
Soundlevel: 45 dBa
Reversible door: No
Built in: No
Freestanding: Yes
Lock: No
UV glass: Yes
Coal filter: No
Interior lighting: LED (white)
Voltage: 220-240V
Power consumption: 70W
Product weight: 19,3 kg
Package weight: 21,5 kg
Product dimensions (WxHxD): 460x738x520
Package dimensions (WxHxD): 510x835x575
Cooling: Thermoelectric
Certification: CE, GS, RoHs
Energy efficiency class: C
Climate class: N
Annual power usage: 191 kwh
Production country: China
EAN: 7090013676166



TREND FW48DB

- Tinted glass door
- Integrated handle
- Dual zone (8-12°C, 12-18°C)
- 18 bottles
- Pull-out metal shelves
- Interior LED lighting
- Digital touchpanel on door
- Low noise
- Vibration-free
- Thermoelectric cooling

Specifications
Bottle capacity: 18
Temperature zones: 2
Temperature: 8-12°C, 12-18°C at 20-25°C room temperature
Shelves: 5
Capacity: 48L
Soundlevel: 38 dBa
Reversible door: No
Built in: No
Freestanding: Yes
Lock: No
UV glass: Yes
Coal filter: No
Interior lighting: LED (white)
Voltage: 220-240V
Power consumption: 100W
Product weight: 22,6 kg
Package weight: 26,7 kg
Product dimensions (WxHxD): 400x848x515
Package dimensions (WxHxD): 475x940x570
Cooling: Thermoelectric
Certification: CE, GS, RoHs
Energy efficiency class: C
Climate class: N
Annual power usage: 197 kwh
Production country: China
EAN: 7090013676159



TREND FW78DB

- Tinted glass door
- Integrated handle
- Dual zone (8-12°C, 12-18°C)
- 32 bottles
- Pull-out metal shelves
- Interior LED lighting
- Digital touchpanel on door
- Low noise
- Vibration-free
- Thermoelectric cooling

Specifications
Bottle capacity: 32
Temperature zones: 2
Temperature: 8-12°C, 12-18°C at 20-25°C room temperature
Shelves: 6
Capacity: 78L
Soundlevel: 38 dBa
Reversible door: No
Built in: No
Freestanding: Yes
Lock: No
UV glass: Yes
Coal filter: No
Interior lighting: LED (white)
Voltage: 220-240V
Power consumption: 140W
Product weight: 23,6 kg
Package weight: 26,4 kg
Product dimensions (WxHxD): 400x845x515
Package dimensions (WxHxD): 475x940x570
Cooling: Thermoelectric
Certification: CE, GS, RoHs
Energy efficiency class: C
Climate class: N
Annual power usage: 238 kwh
Production country: China
EAN: 7090013676173



MW95SBS
Elegant design with a stainless steel framed glass door. Single temperature zone and capacity for up to 34 bottles of wine.

Performance
Exclusive design and perfect drinking temperature

Our PERFORMANCE wine cabinets have an exclusive design and the right storing conditions for your wine collection.

These elegant wine cabinets have an exclusive design with a glass front door with a stainless steel frame and an integrated door handle.

The PERFORMANCE wine cabinets are freestanding units and use compressor cooling. They come with a single temperature zone with a range between 5 to 18°C. This enables you to have the perfect and ideal serving temperature on any type of wine.

The metal shelves can be pulled out and gives a good overview of your wine bottles. The models also features interior LED lighting and digital temperature control. Energy class A+.



PERFORMANCE wine cabinets



PERFORMANCE MW43SBS

- Glass door with stainless steel frame
- Integrated handle
- Single zone (5-18°C)
- 14 bottles
- Pull-out metal shelves
- Interior LED lighting
- Mechanical temp. control
- Freestanding model
- Energy efficiency class A+

Specifications

Bottle capacity: 14
Temperature zones: 1
Temperature: 5-18°C
Shelves: 2
Capacity: 44L
Soundlevel: 42 dBA
Reversible door: No
Built in: No
Freestanding: Yes
Doorlock: No
UV glass: Yes
Coal filter: No
Lightning: LED (blue)
Voltage: 220-240V
Power consumption: 85W
Product weight: 20 kg
Package weight: 22 kg
Product dimensions (WxHxD): 480x492x440
Package dimensions (WxHxD): 530x503x478
Cooling: Compressor
Coolant: R600a (18g)
Certification: CE, RoHS, ErP
Energy efficiency class: A+
Climate class: N
Annual power usage: 105 kwh
Production country: China
EAN: 7090013677323



PERFORMANCE MW95SBS

- Glass door with stainless steel frame
- Integrated handle
- Single zone (5-18°C)
- 34 bottles
- Pull-out metal shelves
- Interior LED lighting
- Digital touch panel
- Freestanding model
- Energy efficiency class A+

Specifications

Bottle capacity: 34
Temperature zones: 1
Temperature: 5-18°C
Shelves: 2
Capacity: 96L
Soundlevel: 42 dBA
Reversible door: No
Built in: No
Freestanding: Yes
Doorlock: No
UV glass: Yes
Coal filter: No
Lightning: LED (blue)
Voltage: 220-240V
Power consumption: 85W
Product weight: 29 kg
Package weight: 31 kg
Product dimensions (WxHxD): 490x842x440
Package dimensions (WxHxD): 530x876x478
Cooling: Compressor
Coolant: R600a (25g)
Certification: CE, RoHS, ErP
Energy efficiency class: A+
Climate class: N
Annual power usage: 138 kwh
Production country: China
EAN: 7090013677330



VWCR46DS

One of our most-selling models. The VWCR46DS with dual temperature zone and capacity for 46 bottles is the perfect choice for any kitchen. With standard dimensions and ventilation in front, it is easy to install!



Standard dimensions for kitchen

The PREMIUM wine cabinets comes in various sizes. Available in 15 cm, 30 cm, 40 cm and 60 cm width. The height is 86,3 cm which makes the wine cabinets fit perfect under the kitchen counter.

Premium Discover the best of your wine!

Our PREMIUM series is specially developed to fit perfectly in the kitchen. With standard dimensions and equipped with front ventilation, the wine cabinets are easy to install under the work top.

The PREMIUM wine cabinets are available in various dimensions, specially designed to be installed in kitchens. With standard measurements and ventilation in front, the wine cabinets can easily be fitted and installed under the kitchen counter. These quality wine cabinets are available with a stainless steel or black slimline front. The wine cabinets are equipped with

interior LED lighting, LCD display, digital temperature and light control, UV-protected glass door, wooden, pull-out shelves and active coal filter for clean air. Available with one or two adjustable temperature zones for ideal serving temperature. With stable and correct temperature and humidity, UV-protection and low vibration you can ensure your wine bottles are stored perfectly.



Small kitchen?

Our VWC7SB is only 15 cm wide and fits 7 bottles of wine. Also available with stainless steel front.



PREMIUM wine cabinets



PREMIUM VWC7SS

- Stainless steel front
- Only 15 cm wide!
- 7 bottles
- Single zone (5-22°C)
- Steel shelves
- Interior LED lighting
- Digital touch panel
- UV-resistant glass door
- Optimal humidity

Specifications

Bottle capacity: 7
Temperature zones: 1
Temperature: 5-22°C
Shelves: 6
Capacity: 22L
Soundlevel: 39 dBa
Reversible door: Yes
Installation type: Built-under
Freestanding: Yes
Lock: No
UV glass: Yes
Coal filter: No
Interior lighting: LED (blue)
Voltage: 220-240V
Power consumption: 63W
Product weight: 15 kg
Package weight: 17 kg
Product dimensions (WxHxD): 148x863x525
Package dimensions (WxHxD): 200x900x600
Cooling: Compressor
Coolant: R600a (14g)
Certification: CE, CB, RoHs
Energy efficiency class: C
Climate class: N
Annual power usage: 215 kwh
Production country: China
EAN: 7090013673332



PREMIUM VWC7SB

- Black slimline front
- Only 15 cm wide!
- 7 bottles
- Single zone (5-22°C)
- Steel shelves
- Interior LED lighting
- Digital touch panel
- UV-resistant glass door
- Optimal humidity

Specifications

Bottle capacity: 7
Temperature zones: 1
Temperature: 5-22°C
Shelves: 6
Capacity: 22L
Soundlevel: 39 dBa
Reversible door: Yes
Installation type: Built-under
Freestanding: Yes
Lock: No
UV glass: Yes
Coal filter: No
Interior lighting: LED (blue)
Voltage: 220-240V
Power consumption: 63W
Product weight: 15 kg
Package weight: 17 kg
Product dimensions (WxHxD): 148x863x525
Package dimensions (WxHxD): 200x900x600
Cooling: Compressor
Coolant: R600a (14g)
Certification: CE, CB, RoHs
Energy efficiency class: C
Climate class: N
Annual power usage: 215 kwh
Production country: China
EAN: 7090013672908



PREMIUM VWC300SS

- Stainless steel front
- 30 cm wide
- 19 bottles
- Single zone (5-22°C)
- Pull-out shelves in wood
- Interior LED lighting
- Digital touch panel
- UV-resistant glass door
- Optimal humidity

Specifications

Bottle capacity: 19
Temperature zones: 1
Temperature: 5-22°C
Shelves: 6
Capacity: 58L
Soundlevel: 39 dBa
Reversible door: Yes
Installation type: Built-under
Freestanding: Yes
Lock: No
UV glass: Yes
Coal filter: Yes
Interior lighting: LED (blue)
Voltage: 220-240V
Power consumption: 88W
Product weight: 29 kg
Package weight: 31 kg
Product dimensions (WxHxD): 295x863x570
Package dimensions (WxHxD): 350x900x600
Cooling: Compressor
Coolant: R600a (19g)
Certification: CE, CB, RoHs
Energy efficiency class: B
Climate class: N
Annual power usage: 169 kwh
Production country: China
EAN: 7090013673356



PREMIUM VWC300SB

- Black slimline front
- 30 cm wide
- 19 bottles
- Single zone (5-22°C)
- Pull-out shelves in wood
- Interior LED lighting
- Digital touch panel
- UV-resistant glass door
- Optimal humidity

Specifications

Bottle capacity: 19
Temperature zones: 1
Temperature: 5-22°C
Shelves: 6
Capacity: 58L
Soundlevel: 39 dBa
Reversible door: Yes
Installation type: Built-under
Freestanding: Yes
Lock: No
UV glass: Yes
Coal filter: Yes
Interior lighting: LED (blue)
Voltage: 220-240V
Power consumption: 88W
Product weight: 29 kg
Package weight: 31 kg
Product dimensions (WxHxD): 295x863x570
Package dimensions (WxHxD): 350x900x600
Cooling: Compressor
Coolant: R600a (19g)
Certification: CE, CB, RoHs
Energy efficiency class: B
Climate class: N
Annual power usage: 169 kwh
Production country: China
EAN: 7090013673366

PREMIUM wine cabinets



PREMIUM VWCR30SS

- Stainless steel front
- 40 cm wide
- 34 bottles
- Single zone (5-22°C)
- Pull-out shelves in wood
- Interior LED lighting
- Digital touch panel
- UV-resistant glass door
- Optimal humidity

Specifications

Bottle capacity: 34
Temperature zones: 1
Temperature: 5-22°C
Shelves: 7
Capacity: 88L
Soundlevel: 39 dBa
Reversible door: Yes
Installation type: Built-under
Freestanding: Yes
Lock: No
UV glass: Yes
Coal filter: Yes
Interior lighting: LED (blue)
Voltage: 220-240V
Power consumption: 100W
Product weight: 38 kg
Package weight: 41 kg
Product dimensions (WxHxD): 380x853x570
Package dimensions (WxHxD): 450x900x650
Cooling: Compressor
Coolant: R600a (17g)
Certification: CE, RoHs
Energy efficiency class: B
Climate class: N
Annual power usage: 193 kwh
Production country: China
EAN: 7090013673066



PREMIUM VWCR30SB

- Black slimline front
- 40 cm wide
- 34 bottles
- Single zone (5-22°C)
- Pull-out shelves in wood
- Interior LED lighting
- Digital touch panel
- UV-resistant glass door
- Optimal humidity

Specifications

Bottle capacity: 34
Temperature zones: 1
Temperature: 5-22°C
Shelves: 7
Capacity: 88L
Soundlevel: 39 dBa
Reversible door: Yes
Installation type: Built-under
Freestanding: Yes
Lock: No
UV glass: Yes
Coal filter: Yes
Interior lighting: LED (blue)
Voltage: 220-240V
Power consumption: 100W
Product weight: 38 kg
Package weight: 41 kg
Product dimensions (WxHxD): 380x853x570
Package dimensions (WxHxD): 450x900x650
Cooling: Compressor
Coolant: R600a (17g)
Certification: CE, RoHs
Energy efficiency class: B
Climate class: N
Annual power usage: 193 kwh
Production country: China
EAN: 7090013675510



PREMIUM VWCR30DS

- Stainless steel front
- 40 cm wide
- 32 bottles
- Dual zone (5-12°C, 12-22°C)
- Pull-out shelves in wood
- Interior LED lighting
- Digital touch panel
- UV-resistant glass door
- Optimal humidity

Specifications

Bottle capacity: 32
Temperature zones: 2
Temperature: 5-12°C, 12-22°C
Shelves: 6
Capacity: 88L
Soundlevel: 39 dBa
Reversible door: Yes
Installation type: Built-under
Freestanding: Yes
Lock: No
UV glass: Yes
Coal filter: Yes
Interior lighting: LED (blue)
Voltage: 220-240V
Power consumption: 100W
Product weight: 38 kg
Package weight: 41 kg
Product dimensions (WxHxD): 380x853x570
Package dimensions (WxHxD): 450x900x650
Cooling: Compressor
Coolant: R600a (17g)
Certification: CE, RoHs
Energy efficiency class: C
Climate class: N
Annual power usage: 237 kwh
Production country: China
EAN: 7090013673219



PREMIUM VWCR30DB

- Black slimline front
- 40 cm wide
- 32 bottles
- Dual zone (5-12°C, 12-22°C)
- Pull-out shelves in wood
- Interior LED lighting
- Digital touch panel
- UV-resistant glass door
- Optimal humidity

Specifications

Bottle capacity: 32
Temperature zones: 2
Temperature: 5-12°C, 12-22°C
Shelves: 6
Capacity: 88L
Soundlevel: 39 dBa
Reversible door: Yes
Installation type: Built-under
Freestanding: Yes
Lock: No
UV glass: Yes
Coal filter: Yes
Interior lighting: LED (blue)
Voltage: 220-240V
Power consumption: 100W
Product weight: 38 kg
Package weight: 41 kg
Product dimensions (WxHxD): 380x853x570
Package dimensions (WxHxD): 450x900x650
Cooling: Compressor
Coolant: R600a (17g)
Certification: CE, RoHs
Energy efficiency class: C
Climate class: N
Annual power usage: 237 kwh
Production country: China
EAN: 7090013675374

PREMIUM wine cabinets



PREMIUM VWCR36DS

- Stainless steel front
- 60 cm wide
- 38 bottles
- Dual zone (5-22°C, 5-22°C)
- Pull-out shelves in wood
- Interior LED lighting
- Digital touch panel
- UV-resistant glass door
- Optimal humidity

Specifications

Bottle capacity: 38
Temperature zones: 2
Temperature: 5-22°C, 5-22°C
Shelves: 2×6
Capacity: 116L
Soundlevel: 39 dBA
Reversible door: No
Installation type: Built-under
Freestanding: Yes
Lock: No
UV glass: Yes
Coal filter: Yes
Interior lighting: LED (blue)
Voltage: 220-240V
Power consumption: 135W
Product weight: 48 kg
Package weight: 52 kg
Product dimensions (WxHxD): 595x863x570
Package dimensions (WxHxD): 650x950x650
Cooling: Compressor
Coolant: R600a (24g)
Certification: CE, RoHS
Energy efficiency class: C
Climate class: N
Annual power usage: 244 kwh
Production country: China
EAN: 7090013673318



PREMIUM VWCR36DB

- Black slimline front
- 60 cm wide
- 38 bottles
- Dual zone (5-22°C, 5-22°C)
- Pull-out shelves in wood
- Interior LED lighting
- Digital touch panel
- UV-resistant glass door
- Optimal humidity

Specifications

Bottle capacity: 38
Temperature zones: 2
Temperature: 5-22°C, 5-22°C
Shelves: 2×6
Capacity: 116L
Soundlevel: 39 dBA
Reversible door: No
Installation type: Built-under
Freestanding: Yes
Lock: No
UV glass: Yes
Coal filter: Yes
Interior lighting: LED (blue)
Voltage: 220-240V
Power consumption: 135W
Product weight: 48 kg
Package weight: 52 kg
Product dimensions (WxHxD): 595x863x570
Package dimensions (WxHxD): 650x950x650
Cooling: Compressor
Coolant: R600a (24g)
Certification: CE, RoHS
Energy efficiency class: C
Climate class: N
Annual power usage: 244 kwh
Production country: China
EAN: 7090013673202



PREMIUM VBC46SS

- Refrigerator for beverages
- 60 cm wide
- Stainless steel front
- Single zone (2-20°C)
- Pull-out shelves in wood
- Interior LED lighting
- Digital touch panel
- UV-resistant glass door
- Compressor cooling

Specifications

Can capacity: 180
Temperature zones: 1
Temperature: 2-20°C
Shelves: 3
Capacity: 145L
Soundlevel: 40 dBA
Reversible door: Yes
Built in: Yes
Freestanding: Yes
Lock: No
UV glass: Yes
Coal filter: Yes
Interior lighting: LED (blue)
Voltage: 220-240V
Power consumption: 100W
Product weight: 44 kg
Package weight: 48 kg
Product dimensions (WxHxD): 595x863x570
Package dimensions (WxHxD): 650x950x650
Cooling: Compressor
Coolant: R600a (29g)
Certification: CE, CB, RoHS
Energy efficiency class: B
Climate class: N
Annual power usage: 164 kwh
Production country: China
EAN: 7090013675381



PREMIUM VWCR46SS

- Stainless steel front
- 60 cm wide
- 46 bottles
- Single zone (5-22°C)
- Pull-out shelves in wood
- Interior LED lighting
- Digital touch panel
- UV-resistant glass door
- Optimal humidity

Specifications

Bottle capacity: 46
Temperature zones: 1
Temperature: 5-22°C
Shelves: 6
Capacity: 145L
Soundlevel: 39 dBA
Reversible door: Yes
Installation type: Built-under
Freestanding: Yes
Lock: Yes
UV glass: Yes
Coal filter: Yes
Interior lighting: LED (blue)
Voltage: 220-240V
Power consumption: 100W
Product weight: 47 kg
Package weight: 51 kg
Product dimensions (WxHxD): 595x863x570
Package dimensions (WxHxD): 650x950x650
Cooling: Compressor
Coolant: R600a (29g)
Certification: CE, CB, RoHS
Energy efficiency class: B
Climate class: N
Annual power usage: 164 kwh
Production country: China
EAN: 7090013673011

PREMIUM wine cabinets



PREMIUM VWCR46DS

- Stainless steel front
- 60 cm wide
- 46 bottles
- Dual zone (5-12°C, 12-22°C)
- Pull-out shelves in wood
- Interior LED lighting
- Digital touch panel
- UV-resistant glass door
- Optimal humidity

Specifications

Bottle capacity: 46
Temperature zones: 2
Temperature: 5-12°C, 12-22°C
Shelves: 6
Capacity: 145L
Soundlevel: 39 dBA
Reversible door: Yes
Installation type: Built-under
Freestanding: Yes
Lock: Yes
UV glass: Yes
Coal filter: Yes
Interior lighting: LED (blue)
Voltage: 220-240V
Power consumption: 100W
Product weight: 47 kg
Package weight: 51 kg
Product dimensions (WxHxD): 595x863x570
Package dimensions (WxHxD): 650x950x650
Cooling: Compressor
Coolant: R600a (29g)
Certification: CE, CB, RoHS
Energy efficiency class: B
Climate class: N
Annual power usage: 164 kwh
Production country: China
EAN: 7090013673301



PREMIUM VWCR46DB

- Black slimline front
- 60 cm wide
- 46 bottles
- Dual zone (5-12°C, 12-22°C)
- Pull-out shelves in wood
- Interior LED lighting
- Digital touch panel
- UV-resistant glass door
- Optimal humidity

Specifications

Bottle capacity: 46
Temperature zones: 2
Temperature: 5-12°C, 12-22°C
Shelves: 6
Capacity: 145L
Soundlevel: 39 dBA
Reversible door: Yes
Installation type: Built-under
Freestanding: Yes
Lock: Yes
UV glass: Yes
Coal filter: Yes
Interior lighting: LED (blue)
Voltage: 220-240V
Power consumption: 100W
Product weight: 47 kg
Package weight: 51 kg
Product dimensions (WxHxD): 595x863x570
Package dimensions (WxHxD): 650x950x650
Cooling: Compressor
Coolant: R600a (29g)
Certification: CE, CB, RoHS
Energy efficiency class: B
Climate class: N
Annual power usage: 164 kwh
Production country: China
EAN: 7090013673370



PREMIUM VWCR46DS82

- Stainless steel front
- 60 cm wide
- 46 bottles
- Dual zone (5-12°C, 12-22°C)
- Pull-out shelves in wood
- Interior LED lighting
- Digital touch panel
- UV-resistant glass door
- Optimal humidity

Specifications

Bottle capacity: 46
Temperature zones: 2
Temperature: 5-12°C, 12-22°C
Shelves: 6
Capacity: 145L
Soundlevel: 39 dBA
Reversible door: Yes
Installation type: Built-in
Freestanding: Yes
Lock: No
UV glass: Yes
Coal filter: Yes
Interior lighting: LED (blue)
Voltage: 220-240V
Power consumption: 100W
Product weight: 47 kg
Package weight: 51 kg
Product dimensions (WxHxD): 595x813x570
Package dimensions (WxHxD): 650x950x650
Cooling: Compressor
Coolant: R600a (30g)
Certification: CE, CB, RoHS
Energy efficiency class: B
Climate class: N
Annual power usage: 164 kwh
Production country: China
EAN: 7090013675534



PREMIUM VWCR46DB82

- Black slimline front
- 60 cm wide
- 46 bottles
- Dual zone (5-12°C, 12-22°C)
- Pull-out shelves in wood
- Interior LED lighting
- Digital touch panel
- UV-resistant glass door
- Optimal humidity

Specifications

Bottle capacity: 46
Temperature zones: 2
Temperature: 5-12°C, 12-22°C
Shelves: 6
Capacity: 145L
Soundlevel: 39 dBA
Reversible door: Yes
Installation type: Built-in
Freestanding: Yes
Lock: No
UV glass: Yes
Coal filter: Yes
Interior lighting: LED (blue)
Voltage: 220-240V
Power consumption: 100W
Product weight: 47 kg
Package weight: 51 kg
Product dimensions (WxHxD): 595x813x570
Package dimensions (WxHxD): 650x950x650
Cooling: Compressor
Coolant: R600a (30g)
Certification: CE, CB, RoHS
Energy efficiency class: B
Climate class: N
Annual power usage: 164 kwh
Production country: China
EAN: 7090013675527

PREMIUM wine cabinets



PREMIUM VWCR100DS

- Stainless steel front
- Dimension: 60 x 120 cm
- 94 bottles
- Dual zone (5-12°C, 12-22°C)
- Pull-out shelves in wood
- Interior LED lighting
- Digital touch panel
- UV-resistant glass door
- Optimal humidity

Specifications

Bottle capacity: 94
Temperature zones: 2
Temperature: 5-12°C, 12-22°C
Shelves: 8
Capacity: 270L
Soundlevel: 40 dBA
Reversible door: Yes
Installation type: Built-in
Freestanding: Yes
Lock: Yes
UV glass: Yes
Coal filter: Yes
Interior lighting: LED (blue)
Voltage: 220-240V
Power consumption: 135W
Product weight: 72 kg
Package weight: 77 kg
Product dimensions (WxHxD): 595x1200x680
Package dimensions (WxHxD): 660x1275x745
Cooling: Compressor
Coolant: R600a (51g)
Certification: CE, CB, RoHS
Energy efficiency class: B
Climate class: N
Annual power usage: 213 kwh
Production country: China
EAN: 7090013673028



PREMIUM VWCR166SS

- Stainless steel front
- Dimension: 60 x 177 cm
- 166 bottles
- Single zone (5-22°C)
- Pull-out shelves in wood
- Interior LED lighting
- Digital touch panel
- UV-resistant glass door
- Optimal humidity

Specifications

Bottle capacity: 166
Temperature zones: 1
Temperature: 5-22°C
Shelves: 15
Capacity: 428L
Soundlevel: 40 dBA
Reversible door: Yes
Installation type: Built-in
Freestanding: Yes
Lock: Yes
UV glass: Yes
Coal filter: Yes
Interior lighting: LED (blue)
Voltage: 220-240V
Power consumption: 190W
Product weight: 100 kg
Package weight: 112 kg
Product dimensions (WxHxD): 595x1775x680
Package dimensions (WxHxD): 660x194x745
Cooling: Compressor
Coolant: R600a (51g)
Certification: CE, CB, RoHS
Energy efficiency class: C
Climate class: N
Annual power usage: 292 kwh
Production country: China
EAN: 7090013673387



PREMIUM VWCR155DS

- Stainless steel front
- Dimension: 60 x 177 cm
- 166 bottles
- Dual zone (5-12°C, 12-22°C)
- Pull-out shelves in wood
- Interior LED lighting
- Digital touch panel
- UV-resistant glass door
- Optimal humidity

Specifications

Bottle capacity: 166
Temperature zones: 2
Temperature: 5-12°C, 12-22°C
Shelves: 14
Capacity: 428L
Soundlevel: 40 dBA
Reversible door: Yes
Installation type: Built-in
Freestanding: Yes
Lock: Yes
UV glass: Yes
Coal filter: Yes
Interior lighting: LED (blue)
Voltage: 220-240V
Power consumption: 190W
Product weight: 102 kg
Package weight: 114 kg
Product dimensions (WxHxD): 595x1775x680
Package dimensions (WxHxD): 660x194x745
Cooling: Compressor
Coolant: R600a (51g)
Certification: CE, CB, RoHS
Energy efficiency class: C
Climate class: N
Annual power usage: 292 kwh
Production country: China
EAN: 7090013673394



PREMIUM VWCR155DB

- Black slimline front
- Dimension: 60 x 177 cm
- 166 bottles
- Dual zone (5-12°C, 12-22°C)
- Pull-out shelves in wood
- Interior LED lighting
- Digital touch panel
- UV-resistant glass door
- Optimal humidity

Specifications

Bottle capacity: 166
Temperature zones: 2
Temperature: 5-12°C, 12-22°C
Shelves: 14
Capacity: 428L
Soundlevel: 40 dBA
Reversible door: Yes
Installation type: Built-in
Freestanding: Yes
Lock: Yes
UV glass: Yes
Coal filter: Yes
Interior lighting: LED (blue)
Voltage: 220-240V
Power consumption: 190W
Product weight: 102 kg
Package weight: 114 kg
Product dimensions (WxHxD): 595x1775x680
Package dimensions (WxHxD): 660x194x745
Cooling: Compressor
Coolant: R600a (51g)
Certification: CE, CB, RoHS
Energy efficiency class: C
Climate class: N
Annual power usage: 292 kwh
Production country: China
EAN: 7090013673400





Modern, seamless design
Specially developed for integration, the OBIU60DBB-3G gives the extra touch to your kitchen. Stylish design with a black glass front with integrated handle. Wooden pull-out shelves and interior LED lighting. Dual temperature zones with capacity for 46 bottles of wine.



OBIU30DSS-3G
Only 30 cm wide but still with dual temperature zones and a storing capacity of 17 bottles.



White design
The OBIU60DW-3G has a clean design with its white glass front door with integrated handle.

Oslo

Modern, seamless design for full integration in the kitchen

The OSLO series with its modern, stylish look is designed for a seamless, full integration in the kitchen.

These high-quality, modern wine cabinets have an exclusive design with a stainless steel or glass front in black or white. With standard dimensions the wine cabinets are easy to install and integrate in any kitchen.

The Oslo wine cabinets are delivered with a single or dual temperature zone which can be regulated separately.

This ensures you to always have the right serving temperature on your wine. Interior LED lighting, LCD display and digital touchpad gives you full control of the temperature and lighting.

With the correct and stable temperature, optimal humidity, low vibration and clean air, you keep your wines at a professional standard.



OBIU60DXL-3G
Modern with an all stainless steel look. 60 cm wide, dual zone and fits 46 bottles.





OBI60SB

Single, adjustable temperature zone with room for 30 bottles. Standard dimension for built-in column.



OBI45SB-T

Modern wine cabinet with black glass front and tip-open door. Single temperature zone and 24 bottles.

Built-in column

Upgrade your kitchen with one of our OSLO built-in column wine cabinets. Easy to install with standard kitchen dimensions at 60 cm width and 45 cm, 60 cm or 124 cm height, they match any other appliances.

Available in stainless steel or with black or white glass door with stainless steel handle. The doors can be hinged as desired.

Pure, white interior LED lighting, digital display and touch panel for controlling light and temperature. Pull-out, wooden shelves. Low energy consumption.



Triple temperature zone

With three temperature zones you can have ready-to-serve sparkling, red and white wine!

Single, dual or triple temperature zone

With our largest built-in column models OBI124 you can choose between single, dual or triple temperature zone. All temperature zones can be regulated separately.

OBI124SB has a single temperature zone which can be regulated from 5°C to 22°C. OBI124DB come with dual temperature zone (5-12°C and 12-22°C). With our triple (5-22°C, 5-12°C and 12-22°C) zone model, OBI124TB, you always have ready-to-serve sparkling, white and red wine!



OBI45SB

Two facing units can also work as a solution for dual temperature zones.

OSLO wine cabinets



- OSLO OBI45SS**
- Seamless stainless steel front
 - Built-in column
 - Single zone (5-22°C)
 - 18 bottles
 - Pull-out shelves in wood
 - Interior LED lighting
 - Digital touch panel
 - UV-resistant glass door
 - Optimal humidity

Specifications
Bottle capacity: 18
Temperature zones: 1
Temperature: 5-22°C
Shelves: 2
Capacity: 55L
Soundlevel: 34 dba
Reversible door: Yes
Installation type: Built-in column
Freestanding: No
Lock: No
UV glass: Yes
Coal filter: Yes
Interior lighting: LED (white)
Voltage: 220-240V
Power consumption: 80W
Product weight: 29 kg
Package weight: 31 kg
Product dimensions (WxHxD): 590x455x555
Package dimensions (WxHxD): 650x525x650
Cooling: Compressor
Coolant: R600a (18g)
Certification: CE, CB, Rohs, Erp
Energy efficiency class: A+
Climate class: N
Annual power usage: 96 kwh
Production country: China
EAN: 7090013676241



- OSLO OBI45SSB**
- Black glass front
 - Built-in column
 - Single zone (5-22°C)
 - 18 bottles
 - Pull-out shelves in wood
 - Interior LED lighting
 - Digital touch panel
 - UV-resistant glass door
 - Optimal humidity

Specifications
Bottle capacity: 18
Temperature zones: 1
Temperature: 5-22°C
Shelves: 2
Capacity: 55L
Soundlevel: 34 dba
Reversible door: Yes
Installation type: Built-in column
Freestanding: No
Lock: No
UV glass: Yes
Coal filter: Yes
Interior lighting: LED (white)
Voltage: 220-240V
Power consumption: 80W
Product weight: 29 kg
Package weight: 31 kg
Product dimensions (WxHxD): 590x455x555
Package dimensions (WxHxD): 650x525x650
Cooling: Compressor
Coolant: R600a (18g)
Certification: CE, CB, Rohs, Erp
Energy efficiency class: A+
Climate class: N
Annual power usage: 96 kwh
Production country: China
EAN: 7090013676029



- OSLO OBI45SW**
- White glass front
 - Built-in column
 - Single zone (5-22°C)
 - 18 bottles
 - Pull-out shelves in wood
 - Interior LED lighting
 - Digital touch panel
 - UV-resistant glass door
 - Optimal humidity

Specifications
Bottle capacity: 18
Temperature zones: 1
Temperature: 5-22°C
Shelves: 2
Capacity: 55L
Soundlevel: 34 dba
Reversible door: Yes
Installation type: Built-in column
Freestanding: No
Lock: No
UV glass: Yes
Coal filter: Yes
Interior lighting: LED (white)
Voltage: 220-240V
Power consumption: 80W
Product weight: 29 kg
Package weight: 31 kg
Product dimensions (WxHxD): 590x455x555
Package dimensions (WxHxD): 650x525x650
Cooling: Compressor
Coolant: R600a (18g)
Certification: CE, CB, Rohs, Erp
Energy efficiency class: A+
Climate class: N
Annual power usage: 96 kwh
Production country: China
EAN: 7090013677460



- OSLO OBI45SB-T**
- Black glass front
 - Built-in column
 - Single zone (5-22°C)
 - 24 bottles
 - Pull-out shelves in wood
 - Interior LED lighting
 - Digital touch panel
 - UV-resistant glass door
 - Optimal humidity

Specifications
Bottle capacity: 24
Temperature zones: 1
Temperature: 5-22°C
Shelves: 3
Capacity: 55L
Soundlevel: 34 dba
Reversible door: No
Installation type: Built-in column
Freestanding: No
Lock: No
UV glass: Yes
Coal filter: Yes
Interior lighting: LED
Voltage: 220-240V
Power consumption: 80W
Product weight: 27,5 kg
Package weight: 31 kg
Product dimensions (WxHxD): 590x455x555
Package dimensions (WxHxD): 650x525x650
Cooling: Compressor
Coolant: R600a (18g)
Certification: CE, CB, Rohs, Erp
Energy efficiency class: A+
Climate class: N
Annual power usage: 96 kwh
Production country: China
EAN: 7090013676876

OSLO wine cabinets



- OSLO OBI60SS**
- Stainless steel front
 - Built-in column
 - Single zone (5-22°C)
 - 30 bottles
 - Pull-out shelves in wood
 - Interior LED lighting
 - Digital touch panel
 - UV-resistant glass door
 - Optimal humidity

Specifications
Bottle capacity: 30
Temperature zones: 1
Temperature: 5-22°C
Shelves: 4
Capacity: 90L
Soundlevel: 37 dba
Reversible door: Yes
Installation type: Built-in column
Freestanding: No
Lock: No
UV glass: Yes
Coal filter: Yes
Interior lighting: LED
Voltage: 220-240V
Product weight: 45 kg
Package weight: 49 kg
Product dimensions (WxHxD): 590x590x590
Package dimensions (WxHxD): 655×655×690
Cooling: Compressor
Coolant: R600a (23g)
Certification: CE, CB, Rohs, Erp
Energy efficiency class: A
Climate class: N
Annual power usage: 141 kwh
Production country: China
EAN: 7090013677422



- OSLO OBI60SB**
- Black glass front
 - Built-in column
 - Single zone (5-22°C)
 - 30 bottles
 - Pull-out shelves in wood
 - Interior LED lighting
 - Digital touch panel
 - UV-resistant glass door
 - Optimal humidity

Specifications
Bottle capacity: 30
Temperature zones: 1
Temperature: 5-22°C
Shelves: 4
Capacity: 90L
Soundlevel: 37 dba
Reversible door: Yes
Installation type: Built-in column
Freestanding: No
Lock: No
UV glass: Yes
Coal filter: Yes
Interior lighting: LED
Voltage: 220-240V
Product weight: 45 kg
Package weight: 49 kg
Product dimensions (WxHxD): 590x590x590
Package dimensions (WxHxD): 655×655×690
Cooling: Compressor
Coolant: R600a (23g)
Certification: CE, CB, Rohs, Erp
Energy efficiency class: A
Climate class: N
Annual power usage: 141 kwh
Production country: China
EAN: 7090013677217



- OSLO OBI60SW**
- White glass front
 - Built-in column
 - Single zone (5-22°C)
 - 30 bottles
 - Pull-out shelves in wood
 - Interior LED lighting
 - Digital touch panel
 - UV-resistant glass door
 - Optimal humidity

Specifications
Bottle capacity: 30
Temperature zones: 1
Temperature: 5-22°C
Shelves: 4
Capacity: 90L
Soundlevel: 37 dba
Reversible door: Yes
Installation type: Built-in column
Freestanding: No
Lock: No
UV glass: Yes
Coal filter: Yes
Interior lighting: LED
Voltage: 220-240V
Product weight: 45 kg
Package weight: 49 kg
Product dimensions (WxHxD): 590x590x590
Package dimensions (WxHxD): 655×655×690
Cooling: Compressor
Coolant: R600a (23g)
Certification: CE, CB, Rohs, Erp
Energy efficiency class: A
Climate class: N
Annual power usage: 141 kwh
Production country: China
EAN: 7090013677415



- OSLO OBI60DB**
- Black glass front
 - Built-in column
 - Dual zone (5-12°C, 12-22°C)
 - 28 bottles
 - Pull-out shelves in wood
 - Interior LED lighting
 - Digital touch panel
 - UV-resistant glass door
 - Optimal humidity

Specifications
Bottle capacity: 28
Temperature zones: 2
Temperature: 5-12°C, 12-22°C
Shelves: 4
Capacity: 90L
Soundlevel: 37 dba
Reversible door: Yes
Installation type: Built-in column
Freestanding: No
Lock: No
UV glass: Yes
Coal filter: Yes
Interior lighting: LED
Voltage: 220-240V
Product weight: 45 kg
Package weight: 49 kg
Product dimensions (WxHxD): 590x590x590
Package dimensions (WxHxD): 655×655×690
Cooling: Compressor
Coolant: R600a (23g)
Certification: CE, CB, Rohs, Erp
Energy efficiency class: A
Climate class: N
Annual power usage: 141 kwh
Production country: China
EAN: 7090013676890

OSLO wine cabinets



OSLO OBI124SB

- Black glass front
- Built-in column
- Single zone (5-22°C)
- 81 bottles
- Pull-out shelves in wood
- Interior LED lighting
- Digital touch panel
- UV-resistant glass door
- Optimal humidity

Specifications

Bottle capacity: 81
Temperature zones: 1
Temperature: 5-22°C
Shelves: 11
Capacity: 230L
Soundlevel: 38 dba
Reversible door: Yes
Installation type: Built-in column
Freestanding: No
Lock: No
UV glass: Yes
Coal filter: Yes
Interior lighting: LED
Voltage: 220-240V
Product weight: 72 kg
Package weight: 77 kg
Product dimensions (WxHxD): 590x1233x590
Package dimensions (WxHxD): 660×1290×680
Cooling: Compressor
Coolant: R600a (32g)
Certification: CE, CB, Rohs, Erp
Energy efficiency class: B
Climate class: N
Annual power usage: 179 kwh
Production country: China
EAN: 7090013677224



OSLO OBI124DB

- Black glass front
- Built-in column
- Dual zone (5-12°C, 12-22°C)
- 74 bottles
- Pull-out shelves in wood
- Interior LED lighting
- Digital touch panel
- UV-resistant glass door
- Optimal humidity

Specifications

Bottle capacity: 74
Temperature zones: 2
Temperature: 5-12°C, 12-22°C
Shelves: 10
Capacity: 230L
Soundlevel: 38 dba
Reversible door: Yes
Installation type: Built-in column
Freestanding: No
Lock: No
UV glass: Yes
Coal filter: Yes
Interior lighting: LED
Voltage: 220-240V
Product weight: 70 kg
Package weight: 73 kg
Product dimensions (WxHxD): 590x1233x590
Package dimensions (WxHxD): 660×1290×680
Cooling: Compressor
Coolant: R600a (33g)
Certification: CE, CB, Rohs, Erp
Energy efficiency class: C
Climate class: N
Annual power usage: 240 kwh
Production country: China
EAN: 7090013677392



OSLO OBI124TB

- Black glass front
- Built-in column
- Triple zone
- 67 bottles
- Pull-out shelves in wood
- Interior LED lighting
- Digital touch panel
- UV-resistant glass door
- Optimal humidity

Specifications

Bottle capacity: 67
Temperature zones: 3
Temperature: 5-22, 5-12, 12-22°C
Shelves: 9
Capacity: 230L
Soundlevel: 38 dba
Reversible door: Yes
Installation type: Built-in column
Freestanding: No
Lock: No
UV glass: Yes
Coal filter: Yes
Interior lighting: LED
Voltage: 220-240V
Product weight: 75 kg
Package weight: 80 kg
Product dimensions (WxHxD): 590x1233x590
Package dimensions (WxHxD): 660×1290×680
Cooling: Compressor
Coolant: R600a (33g)
Certification: CE, CB, Rohs, Erp
Energy efficiency class: C
Climate class: N
Annual power usage: 240 kwh
Production country: China
EAN: 7090013677408

OSLO wine cabinets



OSLO OBIU30DSS-3G

- Seamless stainless steel front
- Built-in under
- Dual zone (5-12°C, 12-22°C)
- 17 bottles
- Pull-out shelves in wood
- Interior LED lighting
- Digital touch panel
- UV-resistant glass door
- Optimal humidity

Specifications

Bottle capacity: 17
Temperature zones: 2
Temperature: 5-12°C, 12-22°C
Shelves: 5
Capacity: 58L
Soundlevel: 39 dBa
Reversible door: Yes
Installation type: Built-in
Freestanding: Yes
Lock: No
UV glass: Yes
Coal filter: No
Interior lighting: LED (white)
Voltage: 220-240V
Power consumption: 88W
Product weight: 29 kg
Package weight: 31 kg
Product dimensions (WxHxD): 295x813x570
Package dimensions (WxHxD): 350x900x600
Cooling: Compressor
Coolant: R600a (17g)
Certification: CE, CB, RoHs
Energy efficiency class: A
Climate class: N
Annual power usage: 139 kwh
Production country: China
EAN: 7090013676708



OSLO OBIU30DW-3G

- White glass front
- Built-in under
- Dual zone (5-12°C, 12-22°C)
- 17 bottles
- Pull-out shelves in wood
- Interior LED lighting
- Digital touch panel
- UV-resistant glass door
- Optimal humidity

Specifications

Bottle capacity: 17
Temperature zones: 2
Temperature: 5-12°C, 12-22°C
Shelves: 5
Capacity: 58L
Soundlevel: 39 dBa
Reversible door: Yes
Installation type: Built-in
Freestanding: Yes
Lock: No
UV glass: Yes
Coal filter: No
Interior lighting: LED (white)
Voltage: 220-240V
Power consumption: 88W
Product weight: 29 kg
Package weight: 31 kg
Product dimensions (WxHxD): 295x813x570
Package dimensions (WxHxD): 350x900x600
Cooling: Compressor
Coolant: R600a (17g)
Certification: CE, CB, RoHs
Energy efficiency class: A
Climate class: N
Annual power usage: 139 kwh
Production country: China
EAN: 7090013677378



OSLO OBIU30DBB-3G

- Black glass front
- Built-in under
- Dual zone (5-12°C, 12-22°C)
- 17 bottles
- Pull-out shelves in wood
- Interior LED lighting
- Digital touch panel
- UV-resistant glass door
- Optimal humidity

Specifications

Bottle capacity: 17
Temperature zones: 2
Temperature: 5-12°C, 12-22°C
Shelves: 5
Capacity: 58L
Soundlevel: 39 dBa
Reversible door: Yes
Installation type: Built-in
Freestanding: Yes
Lock: No
UV glass: Yes
Coal filter: No
Interior lighting: LED (white)
Voltage: 220-240V
Power consumption: 88W
Product weight: 29 kg
Package weight: 31 kg
Product dimensions (WxHxD): 295x813x570
Package dimensions (WxHxD): 350x900x600
Cooling: Compressor
Coolant: R600a (17g))
Certification: CE, CB, RoHs
Energy efficiency class: A
Climate class: N
Annual power usage: 139 kwh
Production country: China
EAN: 7090013676739

OSLO wine cabinets



OSLO OBIU60DSS-3G

- Seamless stainless steel front
- Built-in under
- Dual zone (5-12°C, 12-22°C)
- 46 bottles
- Pull-out shelves in wood
- Interior LED lighting
- Digital touch panel
- UV-resistant glass door
- Optimal humidity

Specifications

Bottle capacity: 46
Temperature zones: 2
Temperature: 5-12°C, 12-22°C
Shelves: 6
Capacity: 145L
Soundlevel: 39 dBA
Reversible door: Yes
Installation type: Built-in
Freestanding: Yes
Lock: No
UV glass: Yes
Coal filter: Yes
Interior lighting: LED (white)
Voltage: 220-240V
Power consumption: 100W
Product weight: 47 kg
Package weight: 51 kg
Product dimensions (WxHxD): 595x813x570
Package dimensions (WxHxD): 650x900x650
Cooling: Compressor
Coolant: R600a (29g)
Certification: CE, CB, RoHs
Energy efficiency class: A
Climate class: N
Annual power usage: 146 kwh
Production country: China
EAN: 7090013676746



OSLO OBIU60DXL-3G

- Seamless stainless steel front
- Built-in under
- Dual zone (5-12°C, 12-22°C)
- 46 bottles
- Pull-out shelves in wood
- Interior LED lighting
- Digital touch panel
- UV-resistant glass door
- Optimal humidity

Specifications

Bottle capacity: 46
Temperature zones: 2
Temperature: 5-12°C, 12-22°C
Shelves: 6
Capacity: 145L
Soundlevel: 39 dBA
Reversible door: Yes
Installation type: Built-in
Freestanding: Yes
Lock: No
UV glass: Yes
Coal filter: Yes
Interior lighting: LED (white)
Voltage: 220-240V
Power consumption: 100W
Product weight: 47 kg
Package weight: 51 kg
Product dimensions (WxHxD): 595x813x570
Package dimensions (WxHxD): 650x900x650
Cooling: Compressor
Coolant: R600a (29g)
Certification: CE, CB, RoHs
Energy efficiency class: A
Climate class: N
Annual power usage: 146 kwh
Production country: China
EAN: 7090013676753



OSLO OBIU60DW-3G

- White glass front
- Built-in under
- Dual zone (5-12°C, 12-22°C)
- 46 bottles
- Pull-out shelves in wood
- Interior LED lighting
- Digital touch panel
- UV-resistant glass door
- Optimal humidity

Specifications

Bottle capacity: 46
Temperature zones: 2
Temperature: 5-12°C, 12-22°C
Shelves: 6
Capacity: 145L
Soundlevel: 39 dBA
Reversible door: Yes
Installation type: Built-in
Freestanding: Yes
Lock: No
UV glass: Yes
Coal filter: Yes
Interior lighting: LED (white)
Voltage: 220-240V
Power consumption: 100W
Product weight: 47 kg
Package weight: 51 kg
Product dimensions (WxHxD): 595x813x570
Package dimensions (WxHxD): 650x900x650
Cooling: Compressor
Coolant: R600a (29g)
Certification: CE, CB, RoHs
Energy efficiency class: A
Climate class: N
Annual power usage: 146 kwh
Production country: China
EAN: 7090013677385



OSLO OBIU60DBB-3G

- Black glass front
- Built-in under
- Dual zone (5-12°C, 12-22°C)
- 46 bottles
- Pull-out shelves in wood
- Interior LED lighting
- Digital touch panel
- UV-resistant glass door
- Optimal humidity

Specifications

Bottle capacity: 46
Temperature zones: 2
Temperature: 5-12°C, 12-22°C
Shelves: 6
Capacity: 145L
Soundlevel: 39 dBA
Reversible door: Yes
Installation type: Built-in
Freestanding: Yes
Lock: No
UV glass: Yes
Coal filter: Yes
Interior lighting: LED (white)
Voltage: 220-240V
Power consumption: 100W
Product weight: 47 kg
Package weight: 51 kg
Product dimensions (WxHxD): 595x813x570
Package dimensions (WxHxD): 650x900x650
Cooling: Compressor
Coolant: R600a (29g)
Certification: CE, CB, RoHs
Energy efficiency class: A
Climate class: N
Annual power usage: 146 kwh
Production country: China
EAN: 7090013676739





Elegance Elegant design with perfect storing conditions

Elegant design combined with optimal wine storage
and serving conditions for your wine collection.

Our ELEGANCE series with its elegant, clean lines is available with front in stainless steel or glass front in black or white finish. The two separate temperature zones (5-12°C and 12-22°C) allows you to store several types of wine with ideal serving temperature. Available in two sizes;

60 cm wide unit with 46 bottle capacity to be fitted under the kitchen counter and a large, freestanding unit with a 153 bottle capacity. Both with the best possible conditions for wine storing. Protected from variations in temperature, humidity, harmful UV-rays and vibration.



Restaurant models

The large Elegance GRN280 models is the perfect choice for use in restaurant and bars. Dual temperature zone and capacity for 153 bottles (more if you remove some shelves).



Stylish, white design

The GRN46DW has a clean and modern design with a white glass front, integrated handle and digital touch panel on the front of the door.

ELEGANCE wine cabinets



ELEGANCE GRN46DB

- Stylish design in black
- Integrated handle
- Dual zone (5-12°C, 12-22°C)
- 46 bottles
- Pull-out shelves in wood
- Interior LED lighting
- Digital touch panel on door
- UV-resistant glass door
- Optimal humidity

Specifications

Bottle capacity: 46
Temperature zones: 2
Temperature: 5-12°C, 12-22°C
Shelves: 6
Capacity: 145L
Soundlevel: 39 dBa
Reversible door: No
Installation type: Built-under
Freestanding: Yes
Lock: No
UV glass: Yes
Coal filter: Yes
Interior lighting: LED (red/blue)
Voltage: 220-240V
Power consumption: 100W
Product weight: 52 kg
Package weight: 56 kg
Product dimensions (WxHxD): 595x863x570
Package dimensions (WxHxD): 660x930x625
Cooling: Compressor
Coolant: R600a (30g)
Certification: CE, CB, RoHs
Energy efficiency class: B
Climate class: N
Annual power usage: 164 kwh
Production country: China
EAN: 7090013675398



ELEGANCE GRN46DW

- Stylish design in white
- Integrated handle
- Dual zone (5-12°C, 12-22°C)
- 46 bottles
- Pull-out shelves in wood
- Interior LED lighting
- Digital touch panel on door
- UV-resistant glass door
- Optimal humidity

Specifications

Bottle capacity: 46
Temperature zones: 2
Temperature: 5-12°C, 12-22°C
Shelves: 6
Capacity: 145L
Soundlevel: 39 dBa
Reversible door: No
Installation type: Built-under
Freestanding: Yes
Lock: No
UV glass: Yes
Coal filter: Yes
Interior lighting: LED (red/blue)
Voltage: 220-240V
Power consumption: 100W
Product weight: 52 kg
Package weight: 56 kg
Product dimensions (WxHxD): 595x863x570
Package dimensions (WxHxD): 660x930x625
Cooling: Compressor
Coolant: R600a (30g)
Certification: CE, CB, RoHs
Energy efficiency class: B
Climate class: N
Annual power usage: 164 kwh
Production country: China
EAN: 7090013675237



ELEGANCE GRNBU46DS

- Stainless steel front
- Handle in stainless steel
- Dual zone (5-12°C, 12-22°C)
- 46 bottles
- Pull-out shelves in wood
- Interior LED lighting
- Digital touch panel on door
- UV-resistant glass door
- Optimal humidity

Specifications

Bottle capacity: 46
Temperature zones: 2
Temperature: 5-12°C, 12-22°C
Shelves: 6
Capacity: 145L
Soundlevel: 39 dBa
Reversible door: No
Installation type: Built-under
Freestanding: Yes
Lock: No
UV glass: Yes
Coal filter: Yes
Interior lighting: LED (red/blue)
Voltage: 220-240V
Power consumption: 100W
Product weight: 52 kg
Package weight: 56 kg
Product dimensions (WxHxD): 595x863x570
Package dimensions (WxHxD): 660x930x625
Cooling: Compressor
Coolant: R600a (30g)
Certification: CE, CB, RoHs
Energy efficiency class: B
Climate class: N
Annual power usage: 164 kwh
Production country: China
EAN: 7090013676043

ELEGANCE wine cabinets



ELEGANCE GRN280DB

- Stylish design in black
- Integrated handle
- Dual zone (5-12°C, 12-22°C)
- 153 bottles
- Pull-out shelves in wood
- Interior LED lighting
- Digital touch panel on door
- UV-resistant glass door
- Optimal humidity

Specifications

Bottle capacity: 153
Temperature zones: 2
Temperature: 5-12°C, 12-22°C
Shelves: 12
Capacity: 490L
Soundlevel: 40 dBa
Reversible door: No
Built in: No
Freestanding: Yes
Lock: Yes
UV glass: Yes
Coal filter: Yes
Interior lighting: LED (red/blue)
Voltage: 220-240V
Power consumption: 190W
Product weight: 128 kg
Package weight: 146 kg
Product dimensions (WxHxD): 655x1835x680
Package dimensions (WxHxD): 700x1970x750
Cooling: Compressor
Coolant: R600a (51g)
Certification: CE, CB, RoHs
Energy efficiency class: D
Climate class: N
Annual power usage: 319 kwh
Production country: China
EAN: 7090013675404



ELEGANCE GRN280DW

- Stylish design in white
- Integrated handle
- Dual zone (5-12°C, 12-22°C)
- 153 bottles
- Pull-out shelves in wood
- Interior LED lighting
- Digital touch panel on door
- UV-resistant glass door
- Optimal humidity

Specifications

Bottle capacity: 153
Temperature zones: 2
Temperature: 5-12°C, 12-22°C
Shelves: 12
Capacity: 490L
Soundlevel: 40 dBa
Reversible door: No
Built in: No
Freestanding: Yes
Lock: Yes
UV glass: Yes
Coal filter: Yes
Interior lighting: LED (red/blue)
Voltage: 220-240V
Power consumption: 190W
Product weight: 128 kg
Package weight: 146 kg
Product dimensions (WxHxD): 655x1835x680
Package dimensions (WxHxD): 700x1970x750
Cooling: Compressor
Coolant: R600a (51g)
Certification: CE, CB, RoHs
Energy efficiency class: D
Climate class: N
Annual power usage: 319 kwh
Production country: China
EAN: 7090013675541



ELEGANCE GRN280DS

- Stainless steel front
- Handle in stainless steel
- Dual zone (5-12°C, 12-22°C)
- 153 bottles
- Pull-out shelves in wood
- Interior LED lighting
- Digital touch panel on door
- UV-resistant glass door
- Optimal humidity

Specifications

Bottle capacity: 153
Temperature zones: 2
Temperature: 5-12°C, 12-22°C
Shelves: 12
Capacity: 490L
Soundlevel: 40 dBa
Reversible door: No
Built in: No
Freestanding: Yes
Lock: Yes
UV glass: Yes
Coal filter: Yes
Interior lighting: LED (red/blue)
Voltage: 220-240V
Power consumption: 190W
Product weight: 128 kg
Package weight: 146 kg
Product dimensions (WxHxD): 655x1835x680
Package dimensions (WxHxD): 700x1970x750
Cooling: Compressor
Coolant: R600a (51g)
Certification: CE, CB, RoHs
Energy efficiency class: D
Climate class: N
Annual power usage: 319 kwh
Production country: China
EAN: 7090013676050



Label-view - designed for professional use!
The CD180SB-B is designed for professional use in restaurants, bars and wine shops. The eye-catching label-view shelves shows off and gives a good overview of the wine collection.

Copenhagen

Show off your wine collection!

These label-view models have a very good exposure of the wine bottles.
For professional use or for the wine connoisseur!

The eye-catching COPENHAGEN wine cabinets comes with two capacities; 38 or 143 bottles with a single temperature zone that can be regulated between 5 to 22°C. The special label-view shelves have the label of the wine bottle exposed in front. This makes it even more easy to keep track

of the wine collection! Designed for professional use in bars, restaurants and wine shops. The shelves can be pulled out completely and fits all kinds of bottle shapes; bordeaux, burgundy, champagne, riesling and even magnums.



COPENHAGEN wine cabinets



COPENHAGEN CDBU60SBB

- “Label-view” shelves
- Black glass front
- 38 bottles
- Single zone (5-22°C)
- Interior LED lighting
- Digital touch panel
- Low vibration
- UV-protected glass door
- Optimal humidity

Specifications

Bottle capacity: 38
Temperature zones: 1
Temperature: 5-22°C
Shelves: 4
Capacity: 145L
Soundlevel: 39 dBA
Reversible door: No
Installation type: Built-under
Freestanding: Yes
Lock: Yes
UV glass: Yes
Coal filter: Yes
Interior lighting: LED (white)
Voltage: 220-240V
Power consumption: 100W
Product weight: 43 kg
Package weight: 47 kg
Product dimensions (WxHxD): 595x813x570
Package dimensions (WxHxD): 660x880x626
Cooling: Compressor
Coolant: R600a (30g)
Certification: CE, CB, Rohs, Erp
Energy efficiency class: A
Climate class: N
Annual power usage: 139 kwh
Production country: China
EAN: 7090013677200



COPENHAGEN CDBU60SXL

- “Label-view” shelves
- Stainless steel front
- 38 bottles
- Single zone (5-22°C)
- Interior LED lighting
- Digital touch panel
- Low vibration
- UV-protected glass door
- Optimal humidity

Specifications

Bottle capacity: 38
Temperature zones: 1
Temperature: 5-22°C
Shelves: 4
Capacity: 145L
Soundlevel: 39 dBA
Reversible door: No
Installation type: Built-under
Freestanding: Yes
Lock: Yes
UV glass: Yes
Coal filter: Yes
Interior lighting: LED (white)
Voltage: 220-240V
Power consumption: 100W
Product weight: 43 kg
Package weight: 47 kg
Product dimensions (WxHxD): 595x813x570
Package dimensions (WxHxD): 660x880x626
Cooling: Compressor
Coolant: R600a (30g)
Certification: CE, CB, Rohs, Erp
Energy efficiency class: A
Climate class: N
Annual power usage: 139 kwh
Production country: China
EAN: 7090013677453



COPENHAGEN CD180SBB

- “Label-view” hyllesystem
- Black glass front
- 143 bottles
- Single zone (5-22°C)
- Interior LED lighting
- Digital touch panel
- Low vibration
- UV-protected glass door
- Optimal humidity

Specifications

Bottle capacity: 143
Temperature zones: 1
Temperature: 5-22°C
Shelves: 12
Capacity: 490L
Soundlevel: 40 dBA
Reversible door: No
Freestanding: Yes
Lock: Yes
UV glass: Yes
Coal filter: Yes
Interior lighting: LED (white)
Voltage: 220-240V
Power consumption: 190W
Product weight: 100 kg
Package weight: 112 kg
Product dimensions (WxHxD): 655x1835x680
Package dimensions (WxHxD): 660x1905x745
Cooling: Compressor
Coolant: R600a (51g)
Certification: CE, CB, Rohs, Erp
Energy efficiency class: B
Climate class: N
Annual power usage: 207 kwh
Production country: China
EAN: 7090013676036



COPENHAGEN CD180SXL

- “Label-view” hyllesystem
- Stainless steel front
- 143 bottles
- Single zone (5-22°C)
- Interior LED lighting
- Digital touch panel
- Low vibration
- UV-protected glass door
- Optimal humidity

Specifications

Bottle capacity: 143
Temperature zones: 1
Temperature: 5-22°C
Shelves: 12
Capacity: 490L
Soundlevel: 40 dBA
Reversible door: No
Freestanding: Yes
Lock: Yes
UV glass: Yes
Coal filter: Yes
Interior lighting: LED (white)
Voltage: 220-240V
Power consumption: 190W
Product weight: 100 kg
Package weight: 112 kg
Product dimensions (WxHxD): 655x1835x680
Package dimensions (WxHxD): 660x1905x745
Cooling: Compressor
Coolant: R600a (51g)
Certification: CE, CB, Rohs, Erp
Energy efficiency class: B
Climate class: N
Annual power usage: 207 kwh
Production country: China
EAN: 7090013677446



Retro fridges

These nostalgic and decorating retro fridges brings the extra touch to your kitchen! Choose between different sizes and colours.

The nostalgic and decorating retro design with the rounded shapes are inspired by the vintage, American styled refrigerators from the 1950’s.

The retro fridges add a stylish touch to your kitchen, mancave, teenager’s room, at the restaurant, bar or in a hotel room.

Our retro fridges combines the authentic 50s retro look with the latest cooling technology. The retro fridges come in various sizes; small mini fridge at 46L, a 115L fridge to place under the counter and a large freestanding unit at 330L with integrated top freezer. Available in different colours; light blue, white, black or red.

Two models (HRF46RBGLASS and HRF130RBGLASS) comes with a glass door which allows you to present the contents in an eye-catching way!



HRF130RLBLUE
Nostalgic and eye-catching design!

Retro fridges



HRF130RLBLUE

- Stylish retro design
- 115L capacity
- Freestanding or built under
- Adjustable glass shelves
- Bottleholder
- Vegetable and fruit tray
- Energy efficiency class A+

Specifications

Capacity: 115L
Colour: Light blue
Interior lighting: LED
Reversible door: No
Lock: No
Soundlevel: 39 dB
Product weight: 31 kg
Package weight: 34 kg
Product dimensions (HxWxD): 835x550x548
Package dimensions (HxWxD): 865x580x595
Voltage: 220-240V
Annual power usage: 100 kwh
Cooling system: Compressor
Coolant: R600a (25g)
Energy efficiency class: A+
Certification: CE, RoHs
Production country: China
EAN: 7090013676517



HRF130RW

- Stylish retro design
- 115L capacity
- Freestanding or built under
- Adjustable glass shelves
- Bottleholder
- Vegetable and fruit tray
- Energy efficiency class A+

Specifications

Capacity: 115L
Colour: White
Interior lighting: LED
Reversible door: No
Lock: No
Soundlevel: 39 dB
Product weight: 31 kg
Package weight: 34 kg
Product dimensions (HxWxD): 835x550x548
Package dimensions (HxWxD): 865x580x595
Voltage: 220-240V
Annual power usage: 100 kwh
Cooling system: Compressor
Coolant: R600a (25g)
Energy efficiency class: A+
Certification: CE, RoHs
Production country: China
EAN: 7090013676470



HRF130RMB

- Stylish retro design
- 115L capacity
- Freestanding or built under
- Adjustable glass shelves
- Bottleholder
- Vegetable and fruit tray
- Energy efficiency class A+

Specifications

Capacity: 115L
Colour: Matte black
Interior lighting: LED
Reversible door: No
Lock: No
Soundlevel: 39 dB
Product weight: 31 kg
Package weight: 34 kg
Product dimensions (HxWxD): 835x550x548
Package dimensions (HxWxD): 865x580x595
Voltage: 220-240V
Annual power usage: 100 kwh
Cooling system: Compressor
Coolant: R600a (25g)
Energy efficiency class: A+
Certification: CE, RoHs
Production country: China
EAN: 7090013676463



HRF130RR

- Stylish retro design
- 115L capacity
- Freestanding or built under
- Adjustable glass shelves
- Bottleholder
- Vegetable and fruit tray
- Energy efficiency class A+

Specifications

Capacity: 115L
Colour: Red
Interior lighting: LED
Reversible door: No
Lock: No
Soundlevel: 39 dB
Product weight: 31 kg
Package weight: 34 kg
Product dimensions (HxWxD): 835x550x548
Package dimensions (HxWxD): 865x580x595
Voltage: 220-240V
Annual power usage:100 kwh
Cooling system: Compressor
Coolant: R600a (25g)
Energy efficiency class: A+
Certification: CE, RoHs
Production country: China
EAN: 7090013677262

Retro fridges



HRF130RBGLASS

- Stylish retro design
- 115L capacity
- Freestanding or built under
- Glass door
- Steel shelves
- Bottleholder
- Energy efficiency class A+

Specifications

Capacity: 115L
Colour: Matt black with glass door
Interior lighting: LED
Reversible door: No
Lock: No
Soundlevel: 39 dB
Product weight: 31 kg
Package weight: 34 kg
Product dimensions (HxWxD): 835x550x548
Package dimensions (HxWxD): 865x580x595
Voltage: 220-240V
Annual power usage: 100 kwh
Cooling system: Compressor
Coolant: R600a (25g)
Energy efficiency class: A+
Certification: CE, RoHs
Production country: China
EAN: 7090013677316



HRF46RBGLASS

- Stylish retro design
- Minibar / minifridge
- 46L capacity
- Freestanding
- Steel shelves
- Glass door
- Energy efficiency class A+

Specifications

Capacity: 46L
Colour: Black with glass door
Interior lighting: No
Reversible door: No
Lock: No
Soundlevel: 39 dBA
Product weight: 20 kg
Package weight: 23 kg
Product dimensions (WxDxH): 430x500x498
Package dimensions (WxDxH): 510x460x510
Voltage: 220V-240V / 50Hz
Annual power usage: 103 kWh
Cooling system: Compressor
Coolant: R600a (17g)
Energy efficiency class: A+
Certification: CE, RoHs, ERP
Production country: China
EAN: 7090013677309



HRF46RMB

- Stylish retro design
- Minibar / minifridge
- 46L capacity
- Freestanding
- Steel shelves
- Energy efficiency class A+

Specifications

Capacity: 46L
Colour: Matt black
Interior lighting: No
Reversible door: No
Lock: No
Soundlevel: 39 dBA
Product weight: 15 kg
Package weight: 17.8 kg
Product dimensions (WxDxH): 430x500x498
Package dimensions (WxDxH): 510x460x510
Voltage: 220V-240V / 50Hz
Annual power usage: 88 kWh
Cooling system: Compressor
Coolant: R600a (17g)
Energy efficiency class: A+
Certification: CE, RoHs, ERP
Production country: China
EAN: 7090013677255



HRF46RR

- Stylish retro design
- Minibar / minifridge
- 46L capacity
- Freestanding
- Steel shelves
- Energy efficiency class A+

Specifications

Capacity: 46L
Colour: Red
Interior lighting: No
Reversible door: No
Lock: No
Soundlevel: 39 dBA
Product weight: 15 kg
Package weight: 17.8 kg
Product dimensions (WxDxH): 430x500x498
Package dimensions (WxDxH): 510x460x510
Voltage: 220V-240V / 50Hz
Annual power usage: 88 kWh
Cooling system: Compressor
Coolant: R600a (17g)
Energy efficiency class: A+
Certification: CE, RoHs, ERP
Production country: China
EAN: 7090013677248

Retro fridges



HRF330RW

- Stylish retro design
- Fridge (260L) with small freezer (21L)
- Adjustable glass shelves
- Bottleholder
- Vegetable and fruit tray
- Energy efficiency class A+

Specifications

Capacity, fridge: 260L
Capacity, freezer: 21L
Colour: White
Interior lighting: LED
Reversible door: No
Lock: No
Soundlevel: 39 dBA
Product weight: 65 kg
Package weight: 70.5 kg
Product dimensions (WxDxH): 600x630x1524
Package dimensions (WxDxH): 695x725x1575
Voltage: 220V-240V / 50Hz
Annual power usage: 212 kWh
Cooling system: Compressor
Coolant: R600a (38g)
Energy efficiency class: A+
Certification: CE, RoHs, ERP
Production country: China
EAN: 7090013677293



HRF330RMB

- Stylish retro design
- Fridge (260L) with small freezer (21L)
- Adjustable glass shelves
- Bottleholder
- Vegetable and fruit tray
- Energy efficiency class A+

Specifications

Capacity, fridge: 260L
Capacity, freezer: 21L
Colour: Matt black
Interior lighting: LED
Reversible door: No
Lock: No
Soundlevel: 39 dBA
Product weight: 65 kg
Package weight: 70.5 kg
Product dimensions (WxDxH): 600x630x1524
Package dimensions (WxDxH): 695x725x1575
Voltage: 220V-240V / 50Hz
Annual power usage: 212 kWh
Cooling system: Compressor
Coolant: R600a (38g)
Energy efficiency class: A+
Certification: CE, RoHs, ERP
Production country: China
EAN: 7090013677279



HRF330RR

- Stylish retro design
- Fridge (260L) with small freezer (21L)
- Adjustable glass shelves
- Bottleholder
- Vegetable and fruit tray
- Energy efficiency class A+

Specifications

Capacity, fridge: 260L
Capacity, freezer: 21L
Colour: Red
Interior lighting: LED
Reversible door: No
Lock: No
Soundlevel: 39 dBA
Product weight: 65 kg
Package weight: 70.5 kg
Product dimensions (WxDxH): 600x630x1524
Package dimensions (WxDxH): 695x725x1575
Voltage: 220V-240V / 50Hz
Annual power usage: 212 kWh
Cooling system: Compressor
Coolant: R600a (38g)
Energy efficiency class: A+
Certification: CE, RoHs, ERP
Production country: China
EAN: 7090013677286



PC-40W
Practical and eye-catching partycooler.

Partycooler

Keep your beverages cold on hot summer days!
Stylish and eye-catching partycooler on wheels.

This practical and eye-catching partycooler has a compact design and wheels, making it mobile and easy to move around. The PC-40W has a 40 liter capacity with room for 60 pieces of 33 cl cans. It has a powerful compressor with a temperature range from 2-10°C.

- Easy access to the beverages with a split, transparent top lid.
- A partycooler is a must-have at the summer party or for use on the terrace, outdoor restaurants, bars and catering.
- The partycooler comes with a silver-look, but is possible to brand with your own individual design.



- PC-40W**

 - Eye-catching design
 - Temperature range 2-10°C
 - On wheels
 - Compressor
 - 40L capacity
- Specifications**

Capacity: 40L	Certification: CE, RoHs
Colour: Silver	Voltage: 92W
Temperature: 2-10°C	Power consumption: 0,7kWh/24h
Product weight: 17 kg	Coolant: R600a (20g)
Package weight: 19 kg	Cooling: Compressor
Product dimensions (WxHxD): 442x745x442	Production country: China
Package dimensions (WxHxD): 460x780x460	EAN: 7090013675701

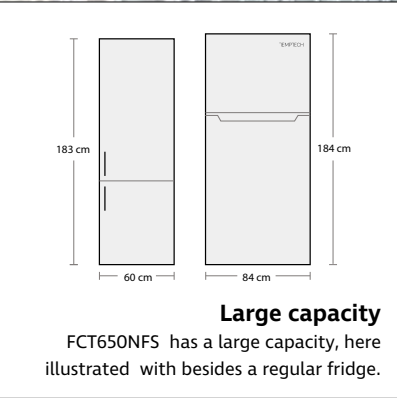

Fridge

Our new HERREGAARD FCT650NFS refrigerator is a large fridge with huge capacity (650L) - perfect for the large family!

Refrigerator with top freezer and a huge capacity. Ideal for the large family, the workplace or as an extra fridge. 84 cm wide and full height of 186 cm. Practical and well equipped with multiple spill-proof glass shelves, bottle and door shelves,

vegetable and fruit trays and separate dairy zones. Interior LED lighting and mechanical temperature control. Non-frost. Energy efficiency class A+.



- HERREGAARD FCT650NFS**

 - Large refrigerator with freezer on top
 - 650L capacity (489L fridge, 161L freezer)
 - 84x186 cm
 - Energy efficiency class A+
 - LED-lighting
- Specifications**

Capacity: 650L (fridge: 489L, freezer: 161L)	Product dimension (WxDxH): 834x820x1860
Colour: Silver	Package dimensions (WxDxH): 887x850x1935
Interior lighting: LED	Voltage: 220V-240V / 50Hz
Non-frost: Yes	Power usage: 475 kwh
Reversible door: Yes	Cooling: Compressor
Lock: No	Coolant: R600a (73g)
Soundlevel: 45 dBA	Energy efficiency class: A+
Weight: 100 kg	Certification: CE, Rohs, ERP
Package weight: 111 kg	Production country: China
	EAN: 7090013677347



HMF46BSG
Minifridge with compressor.
Glass door, LED lighting.

Minibar and minifridges

Small minibars and minifridges for cold beverages for professional or home use.

These minibars and minifridges is a perfect choice for smaller spaces - easy to fit it and easy to move around.

Low priced, attractive design and high quality products suitable for any occasion, either for professional or home use.

The minibars uses thermoelectric cooling and has a temperature range of 5 to 8°C. As for the minifridges, which uses a compressor, the temperature range is between 5 to 10°C. To reach the ideal temperature the surrounding room temperature needs to be 20-25°C.



MB-17W
Thermoelectric minibar for cold beverages. Low noise and no vibration.

Minibar and minifridges



- BCH-32G**
- Thermoelectric cooling
 - Temperature range 5-8°C
 - Glass door
 - Interior LED lighting
 - Energy efficiency class A
 - Low noise
 - Low vibration

Specifications
Capacity: 32L
Temperature: 5-8°C at 20-25°C room temperature
Colour: Black
Door: Glass door
Reversible door: Yes
Lock: Yes
Interior lighting: LED
Product weight: 10 kg
Package weight: 11,5 kg
Product dimensions (WxDxH): 380x445x475
Package dimensions (WxDxH): 430x510x520
Energy efficiency class: A
Voltage: 220-240V
Annual power usage: 131 kwh
Cooling: Thermoelectric
Certification: CE, Rohs
Voltage: 220-240V
Production country: China
EAN: 7090013676272



- HMF46BSG**
- Compressor cooling
 - Temperature range 5-10°C
 - Glass door
 - Interior LED lighting
 - Energy efficiency class A+
 - Low noise
 - Low vibration

Specifications
Capacity: 46L
Temperature: 5-10°C at 20-25°C room temperature
Colour: Black
Door: Glass door
Reversible door: No
Lock: No
Interior lighting: LED
Sound level: 39 dB
Product weight: 16 kg
Package weight: 17 kg
Product dimensions (WxHxD): 510x430x475
Package dimensions (WxHxD): 525x460x510
Voltage: 220-240V
Annual power usage: 103 kwh
Cooling: Compressor
Coolant: R600a (19g)
Energy efficiency class: A+
Certification: CE, Rohs
Production country: China
EAN: 7090013676425



- MB-17W**
- Thermoelectric cooling
 - Temperature range 5-8°C
 - Interior LED lighting
 - Energy efficiency class A+
 - Low noise
 - Low vibration
- Specifications**
Capacity: 17L
Temperature: 5-8°C at 20-25°C room temperature
Colour: White
Door: Full door
Interior lighting: LED
Reversible door: No
Lock: No
Sound level: 38 dB
Product weight: 7,3 kg
Package weight: 8,6 kg
Product dimensions (WxHxD): 385x341x422
Package dimensions (WxHxD): 423x430x460
Voltage: 220-240V
Annual power usage: 82 kwh
Cooling: Thermoelectric
Energy efficiency class: A+
Certification: CE, Rohs
Production country: China
EAN: 7090013676289



Backbar

Backbar / beer coolers with double-glazed glass doors, interior LED lighting and mirror interior. For professional use in bars, restaurants and retail.

Compact under-counter backbars (or beer/bar coolers) for maximum storage space for bottles and cans with great efficiency and functionality. For professional use in bars, restaurants and retail.

These competitively priced backbars comes in various sizes; 50 cm, 60 cm, 90 cm and 133,5 cm. Because of its height of 84 cm, the backbar will fit under almost any counter or bar.

With these backbars you can chill down your beverages fast to a serving temperature between 2°C and 10°C.

The double-glazed glass door, interior LED lighting, adjustable wire shelves and mirror provides a good exposure and clear view of the contents in the fridge. The backbars are delivered with a door lock, digital control and display of temperature.



BB118B1H
50 cm backbar for
storing cold beverages.

Backbar



BB118B1H

- 108L capacity
- 50 cm
- Double-glazed glass door
- Interior LED lighting
- Powerful compressor
- Temperature range 2-10°C
- Door lock
- Adjustable wire shelves
- Interior mirror

Specifications

Capacity: 108L
Temperature: 2-10°C
Colour: Black
Interior lighting: LED
Product dimensions (WxDxH): 500x500x840
Package dimensions (WxDxH): 560x560x900
Product weight: 35 kg
Package weight: 38 kg
Door: Double-glazed glass door
Reversible door: No
Lock: Yes
Voltage: 220-240V/50Hz
Cooling: Compressor
Coolant: R600 (35g)
Certification: CE
Production country: China
EAN: 7090013675350



BB138B1H

- 128L capacity
- 60 cm
- Double-glazed glass door
- Interior LED lighting
- Powerful compressor
- Temperature range 2-10°C
- Door lock
- Adjustable wire shelves
- Interior mirror

Specifications

Capacity: 128L
Temperature: 2-10°C
Colour: Black
Interior lighting: LED
Product dimensions (WxDxH): 600x500x840
Package dimensions (WxDxH): 660x560x900
Product weight: 42 kg
Package weight: 44 kg
Door: Double-glazed glass door
Reversible door: No
Lock: Yes
Voltage: 220-240V/50Hz
Cooling: Compressor
Coolant: R600 (40g)
Certification: CE
Production country: China
EAN: 7090013675664



BB228B2S

- 208L capacity
- 90 cm
- Double-glazed glass door
- Interior LED lighting
- Powerful compressor
- Temperature range 2-10°C
- Door lock
- Adjustable wire shelves
- Interior mirror

Specifications

Capacity: 208L
Temperature: 2-10°C
Colour: Black
Interior lighting: LED
Product dimensions (WxDxH): 900x500x840
Package dimensions (WxDxH): 960x560x900
Product weight: 56 kg
Package weight: 58 kg
Door: Double-glazed glass door
Reversible door: No
Lock: Yes
Voltage: 220-240V/50Hz
Cooling: Compressor
Coolant: R600 (50g)
Certification: CE
Production country: China
EAN: 7090013675367



BB338B3S

- 318L capacity
- 133,5 cm
- Double-glazed glass door
- Interior LED lighting
- Powerful compressor
- Temperature range 2-10°C
- Door lock
- Adjustable wire shelves
- Interior mirror

Specifications

Capacity: 318L
Temperature: 2-10°C
Colour: Black
Interior lighting: LED
Product dimensions (WxDxH): 1335x500x840
Package dimensions (WxDxH): 1390x560x900
Product weight: 76 kg
Package weight: 79 kg
Door: Double-glazed glass door
Reversible door: No
Lock: Yes
Voltage: 220-240V/50Hz
Cooling: Compressor
Coolant: R600 (80g)
Certification: CE
Production country: China
EAN: 7090013675329



C100S
Our largest display fridge with 880L capacity, double-glazed, sliding glass doors, adjustable shelves and branding area at top.

Display fridge

High quality display fridges for professional use in food services and retail.

Our display fridges combines efficient cooling, good exposure and product presentation. Designed for professional use in food services and retail.

Powerful compressor with recirculating air cooling maintains a reliable and accurate temperature at a range from 2 to 10°C.

Personalize the fridge with your own design at the top area. This will enable an increase of volumes, product exposure and marketing.

Double-glazed glass doors, interior LED lighting, adjustable wire shelves and digital control and display of temperature.



BC293B1H and BC458B2H
Display fridges with mirror interior that gives the products a good exposure!

Display fridge



- BC293B1H**
- 293L capacity
 - Double-glazed glass door
 - Interior LED lighting
 - Powerful compressor
 - Temperature range 2-10°C
 - Door lock
 - Adjustable wire shelves
 - Interior mirror

Specifications
Capacity: 293L
Temperature: 2-10°C
Colour: Black
Interior lighting: LED
Product dimensions (WxDxH): 600x515x1840
Package dimensions (WxDxH): 650x600x1900
Product weight: 73 kg
Package weight: 76 kg
Door: Double-glazed glass door
Reversible door: No
Lock: Yes
Voltage: 220-240V/50Hz
Cooling: Compressor
Coolant: R134 (120g)
Certification: CE
Production country: China
EAN: 7090013675671



- BC458B2H**
- 458L capacity
 - Double-glazed glass door
 - Interior LED lighting
 - Powerful compressor
 - Temperature range 2-10°C
 - Door lock
 - Adjustable wire shelves
 - Interior mirror

Specifications
Capacity: 458L
Temperature: 2-10°C
Colour: Black
Interior lighting: LED
Product dimensions (WxDxH): 900x515x1840
Package dimensions (WxDxH): 955x580x1890
Product weight: 105 kg
Package weight: 108 kg
Door: Double-glazed glass door
Reversible door: No
Lock: Yes
Voltage: 220-240V/50Hz
Cooling: Compressor
Coolant: R134 (150g)
Certification: CE
Production country: China
EAN: 7090013675589



- DC280B1H**
- 280L capacity
 - Double-glazed glass door
 - Interior LED lighting
 - Powerful compressor
 - Temperature range 2-10°C
 - Door lock
 - Adjustable wire shelves
 - Highlighted branding in top

Specifications
Capacity: 280L
Temperature: 2-10°C
Colour: Black
Interior lighting: LED
Product dimensions (WxDxH): 590x593x1940
Package dimensions (WxDxH): 660x645x1950
Product weight: 76 kg
Package weight: 79 kg
Door: Double-glazed glass door
Reversible door: No
Lock: Yes
Voltage: 220-240V/50Hz
Daily power consumption: 4,7 kWh
Cooling: Compressor
Coolant: R600 (80g)
Certification: CE
Production country: China
EAN: 7090013675688



- DC750B2H**
- 750L capacity
 - Double-glazed glass door
 - Interior LED lighting
 - Powerful compressor
 - Temperature range 2-10°C
 - Door lock
 - Adjustable wire shelves
 - Highlighted branding in top

Specifications
Capacity: 750L
Temperature: 2-10°C
Colour: Black
Interior lighting: LED
Product dimensions (WxDxH): 1160x670x1980
Package dimensions (WxDxH): 1220x710x2035
Product weight: 129 kg
Package weight: 133 kg
Door: Double-glazed glass door
Reversible door: No
Lock: Yes
Voltage: 220-240V/50Hz
Daily power consumption: 4,7 kWh
Cooling: Compressor
Coolant: R134a (220g)
Certification: CE
Production country: China
EAN: 7090013675695

Display fridge



DC110B1H

- 110L capacity
- Double-glazed glass door
- Interior LED lighting
- Powerful compressor
- Temperature range 2-10°C
- Door lock
- Adjustable wire shelves
- Highlighted branding in top

Specifications

Capacity: 110L
Temperature: 2-10°C
Colour: Black
Interior lighting: LED
Product dimensions (WxDxH): 360x370x1880
Package dimensions (WxDxH): 400x400x2000
Product weight: 60 kg
Package weight: 63 kg
Door: Double-glazed glass door
Reversible door: No
Lock: Yes
Daily power consumption: 2,85kWh
Voltage: 220-240V/50Hz
Certification: CE, RoHS
Cooling: Compressor
Coolant: R600a (70g)
Production country: China
EAN: 7090013676258



C700S

- 682L capacity
- Double-glazed, sliding glass door
- Interior LED lighting
- Powerful compressor
- Temperature range 0-10°C
- Door lock
- Adjustable wire shelves
- Highlighted branding in top

Specifications

Capacity: 682L
Temperature: 0-10°C
Colour: Black
Interior lighting: LED
Product dimensions (WxDxH): 865x690x1990
Package dimensions (WxDxH): 950x750x2100
Product weight: 129 kg
Package weight: 140 kg
Door: Double-glazed glass door
Reversible door: No
Lock: Yes
Voltage: 220-240V/50Hz
Daily power consumption: 4,7 kWh
Cooling: Compressor
Coolant: R290 (100g)
Certification: CE
Production country: China
EAN: 7090013675732



C1000S

- 880L capacity
- Double-glazed, sliding glass door
- Interior LED lighting
- Powerful compressor
- Temperature range 0-10°C
- Door lock
- Adjustable wire shelves
- Highlighted branding in top

Specifications

Capacity: 880L
Temperature: 0-10°C
Colour: Black
Interior lighting: LED
Product dimensions (WxDxH): 1200x690x1980
Package dimensions (WxDxH): 1250x750x2100
Product weight: 153 kg
Package weight: 160 kg
Door: Double-glazed glass door
Reversible door: No
Lock: Yes
Voltage: 220-240V/50Hz
Daily power consumption: 5,5 kWh
Cooling: Compressor
Coolant: R290 (100g)
Certification: CE
Production country: China
EAN: 7090013675749





Icemaker

Icemakers with large capacity for efficient production of square-shaped, crystal clear ice cubes. Freestanding units with a long durability.
For professional use in restaurants, bars and kitchens.



Icemaker



IceQueen ICEQ555

- 25 kg daily production
- 20 kg ice storage capacity
- Square-shaped ice cubes
- Freestanding
- Fits under the counter
- Stainless steel finish

Specifications

Daily production: 25 kg
Ice cube shape: Square
Storage capacity: 20 kg
Water/drain connection: Yes
Cooling: Air
Voltage: 220-240V
Power consumption: 260W
Product weight: 38 kg
Package weight: 45 kg
Product dimensions (WxHxD): 510x450x840
Package dimensions (WxHxD): 550x570x960
Certification: CE, Rohs
Coolant: R134a (190g)
EAN: 7090013676340



IceQueen ICEQ100S

- 50 kg daily production
- 27 kg ice storage capacity
- Square-shaped ice cubes
- Freestanding
- Stainless steel finish

Specifications

Daily production: 50 kg
Ice cube shape: Square
Storage capacity: 27 kg
Water/drain connection: Yes
Cooling: Air
Voltage: 220-240V
Power consumption: 350W
Product weight: 42 kg
Package weight: 54 kg
Product dimensions (WxHxD): 510x600x840
Package dimensions (WxHxD): 590x680x970
Certification: CE, Rohs
Coolant: R134a (280g)
EAN: 7090013676357



IceQueen ICEQ210S

- 100 kg daily production
- 40 kg ice storage capacity
- Square-shaped ice cubes
- Freestanding
- Stainless steel finish

Specifications

Daily production: 100 kg
Ice cube shape: Square
Storage capacity: 40 kg
Water/drain connection: Yes
Cooling: Air
Voltage: 220-240V
Power consumption: 750W
Product weight: 62 kg
Package weight: 76 kg
Product dimensions (WxHxD): 670x680x900
Package dimensions (WxHxD): 790x800x1060
Certification: CE, Rohs
Coolant: R404a (400g)
EAN: 7090013676371



IceMonster ICEM1000T

- 300 kg daily production
- 200 kg ice storage capacity
- Square-shaped ice cubes
- Freestanding
- Stainless steel finish

Specifications

Daily production: 300 kg
Ice cube shape: Square
Storage capacity: 200 kg
Water/drain connection: Yes
Cooling: Water
Voltage: 220-240V
Power consumption: 2350W
Product weight: 112 kg
Package weight: 129 kg
Product dimensions (WxHxD): 785x833x1080
Package dimensions (WxHxD): 930x820x1220
Certification: CE, Rohs
Coolant: R404a (1500g)
EAN: 7090013676401

INSTALLATION DRAWINGS FOR PREMIUM, ELEGANCE & OSLO WINE CABINETS

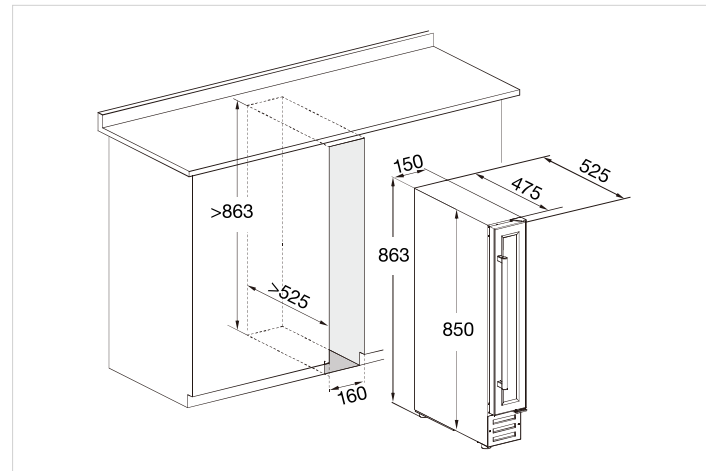

Models: VWC7SS, VWC7SB

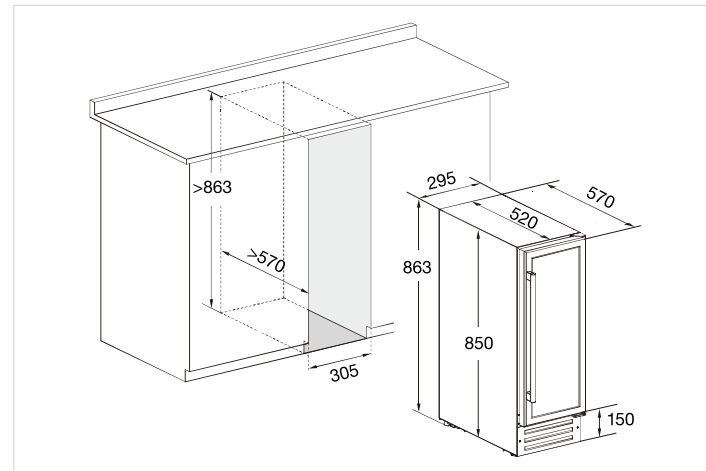

Models: VWC300SS, VWC300SB

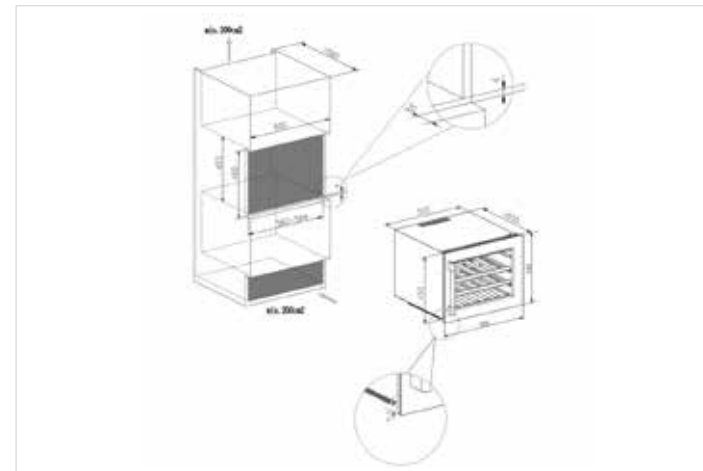

Models: OBI45SS, OBI45SB, OBI45SW, OBI45SB-T

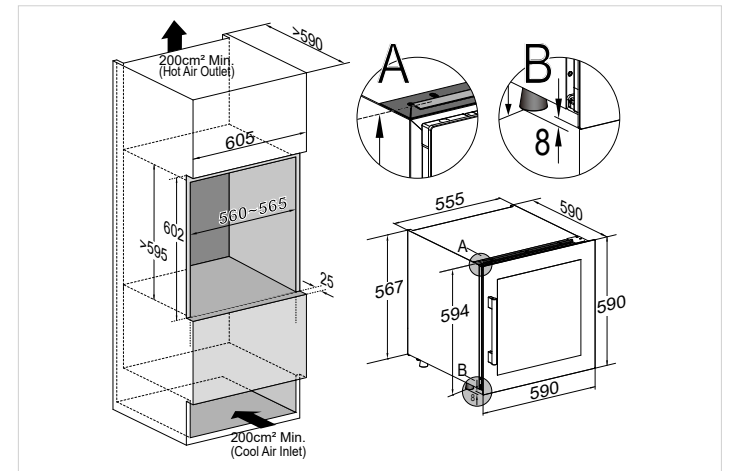

Models: OBI60SS, OBI60SB, OBI60SW, OBI60DB

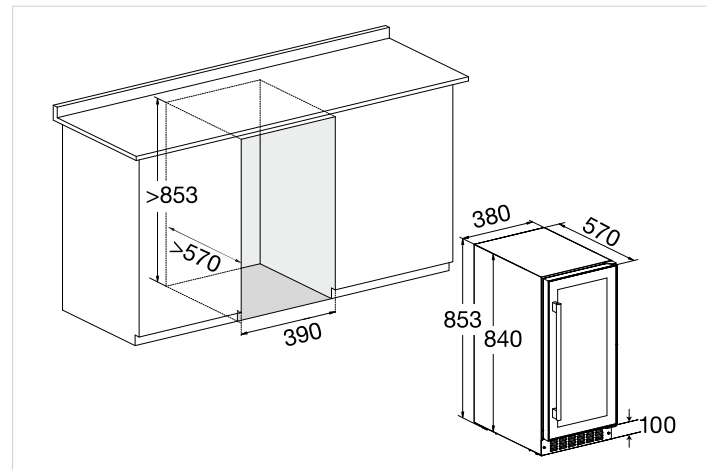

Models: VWCR30DS, VWCR30SS, VWCR30DB, VWCR30SB

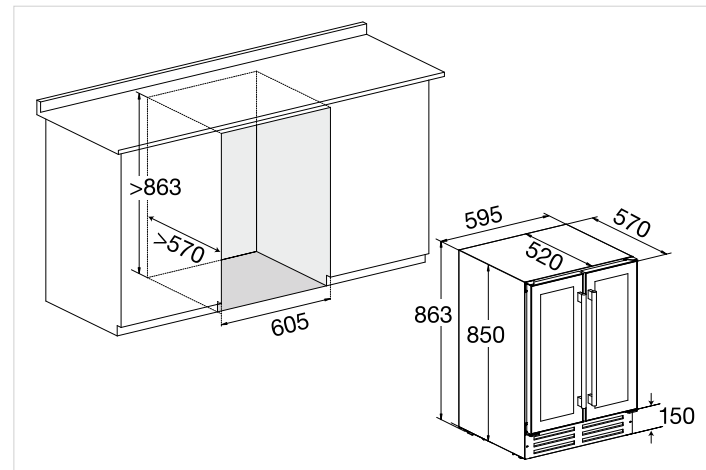

Models: VWCR36DS, VWCR36DB

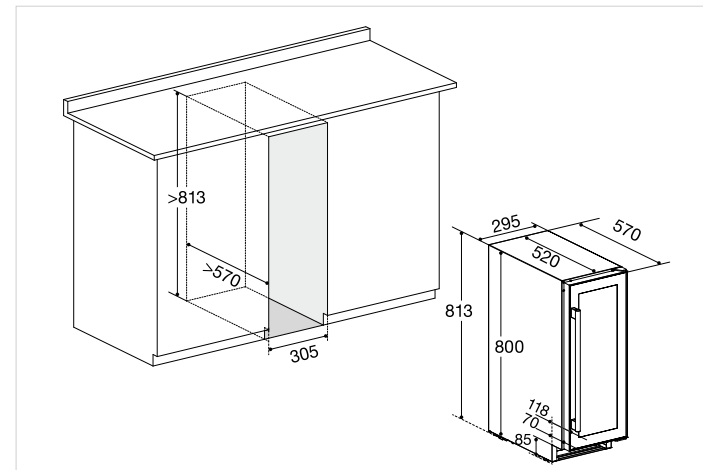

Models: OBIU30DBB, OBIU30DSS, OBIU30DW

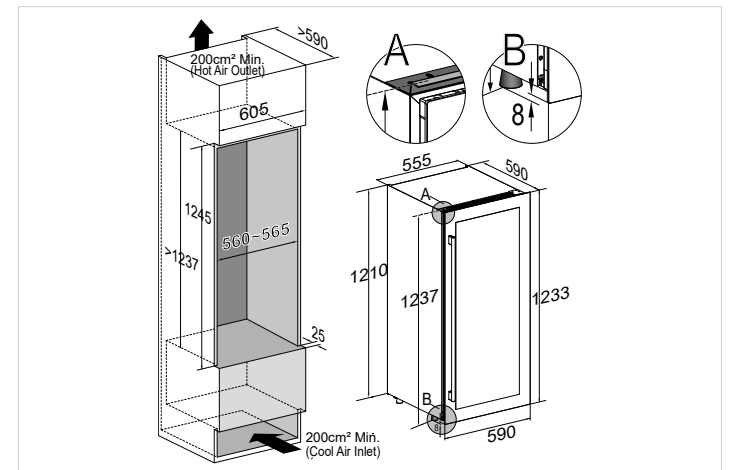

Models: OBI124SB, OBI124DB, OBI124TB

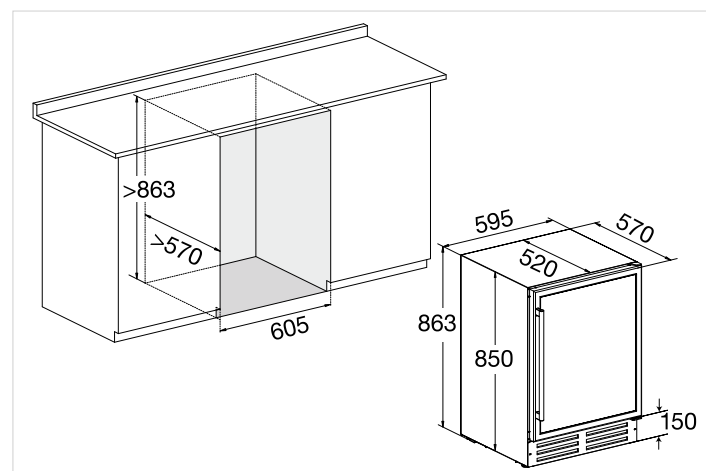

Models: VVWCR46DS, VVWCR46SS, VVWCR46DB, VBC46SS, GRN46DB, GRN46DW, GRNBU46DS, CDBU60SBB

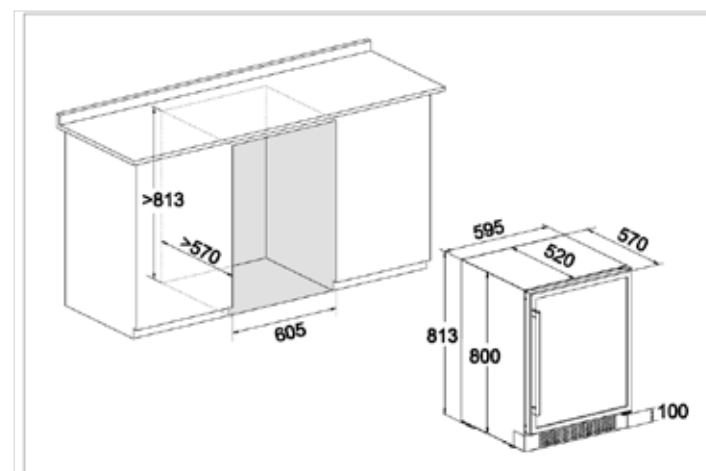

Models: VWCR46DS82, VWCR46DB82, OBIU60DSS, OBIU60DXL, OBIU60DBB, OBIU60DW

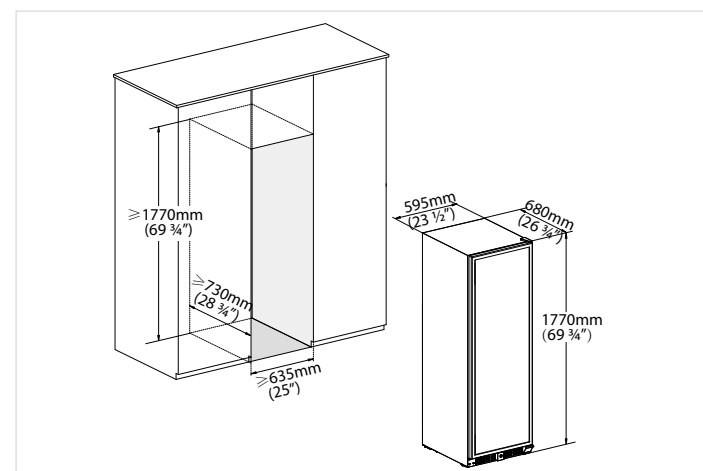

Models: VWCR155DS, VWCR166SS, VWCR155DB

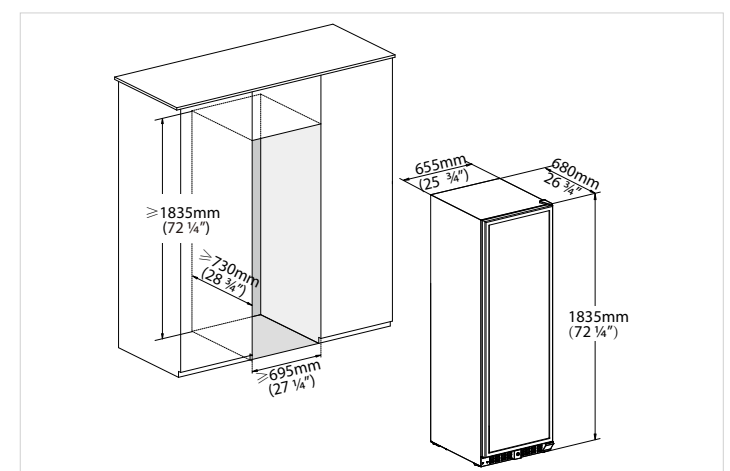

Models: GRN280DB, GRN280DW, GRN280DS

TEMPTECH

Discover the best of your wine.

